



QUALITY FIXTURE AND SERVICE

SINCE 1989

www.kinlai.ca



Welcome to Kin-Lai Store Fixtures!

In business for more than 25 years, Kin-Lai provides well-designed, high-quality store fixture products while striving to maintain extraordinary customer satisfaction. Our professional staff is always approachable, attentive, and knowledgeable.

Kin-Lai's extensive range of fixtures and components meets an equally broad range of requirements. We know our customers arrive with specific requirements and budgets in mind. Our custom-design service always provides the best combination of functional solutions and exceptional value.

Toronto is home to our Canada/US operation, supported by our more than 2,500,000 sq.ft. of manufacturing facility in Asia. The city is a major transportation hub allowing us to serve customers throughout North America.

Our distribution channels, market strategy, locations, inventory, and competitive pricing make us one of the top rank companies in this industry in Canada.

At Kin-Lai, we are proud of our products and pleased to provide focused solutions to your specific store fixture requirements.

Thank you for your patronage.

CONTENTS



RACKS & ACCESSORIES

- TWO WAY RACKS
- FOUR WAY RACKS
- SUPER FOUR WAY RACKS
- DISPLAY ARMS
- ROUND RACKS
- DOUBLE HANGRAIL RACKS
- ACCESSORIES RACKS
- GARMENT RACKS
- CASTERS
- SHOE RACKS AND ACCESSORIES

08

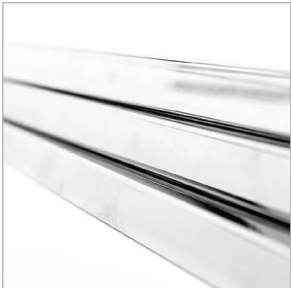

OUTRIGGERS & WALL STANDARDS

- OUTRIGGER SYSTEMS
- WALL STANDARDS

28



BRACKETS & ACCESSORIES

- SHELF BRACKETS
- BRACKETS FOR ROUND TUBING
- ACCESSORIES FOR WALL STANDARDS
- CROSSBAR ACCESSORIES
- WALL MOUNT ACCESSORIES

33



HANGRAILS & ACCESSORIES

- RECTANGULAR HANGRAILS
- ROUND HANGRAILS
- SQUARE HANGRAILS

44

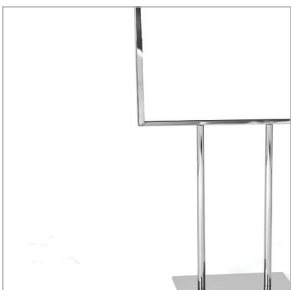

METAL SIGN HOLDERS & ACCESSORIES

- BULLETIN STANDS
- CARD FRAMES
- SIGN CLAMPS AND STEMS

51



GRID PANELS & ACCESSORIES

- GRID AND SLATGRID PANELS
- GRID PANEL FASTENING DEVICES
- GRID PANEL CONNECTORS
- GRID PANEL ACCESSORIES

61



SLATWALL ACCESSORIES

74



BINNING CONNECTORS

83



ACRYLIC SIGN HOLDERS

84



COUNTER TOP DISPLAYERS

88

CONTENTS

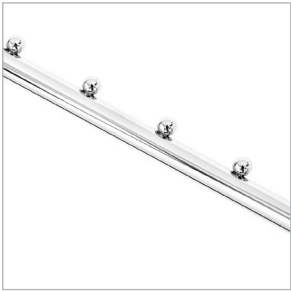

PEGBOARD ACCESSORIES

89



STACKING BASKETS & DUMP BINS

90



METAL WIRE SHELVING SYSTEM

93



HANGERS

96



WIRE BASKETS & SHELVES

98

AVAILABLE FINISHES:

CHR - CHROME ● ZNC - ZINC ● BLK - BLACK ● WHT - WHITE ○
SAT CHR - SATIN CHROME ● RAW - RAW FINISH ●





0100

Two straight arms - square tubing.



0101

One straight and one slant arm with balls - square tubing.

0102

Two slant arms with balls - square tubing.

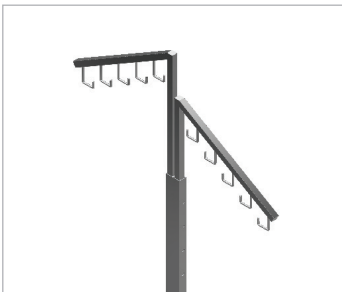

0103

Two slant arms with hooks - square tubing.

0104

Two straight arms - rectangular tubing.



0105

One straight and one slant arm with balls - rectangular tubing.

0106

Two slant arms with balls - rectangular tubing.

Note: Heavy duty 15" x 12" base. Single upright of 1" x 2" rectangular tubing. Available finish: chrome. Arms are adjustable every 3" from 48" to 72". Special colours are available upon request.

0200

Two straight arms - square tubing.



0201

One straight and one slant arm with balls - square tubing.



0202

Two slant arms with balls - square tubing.

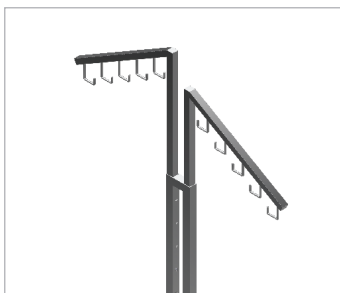

0203

Two slant arms with hooks - square tubing.

0204

Two straight arms - rectangular tubing.



0205

One straight and one slant arm with balls - rectangular tubing.

0206

Two slant arms with balls - rectangular tubing.



0207

One bow arm and one slant arm with balls - square tubing.

0208

One bow arm and one straight arm - square tubing.

Note: Heavy duty 15" x 12" base. Upright of two 1" square tubing. Available finish: chrome. Arms are adjustable every 3" from 48" to 72". Special colours are available upon request.

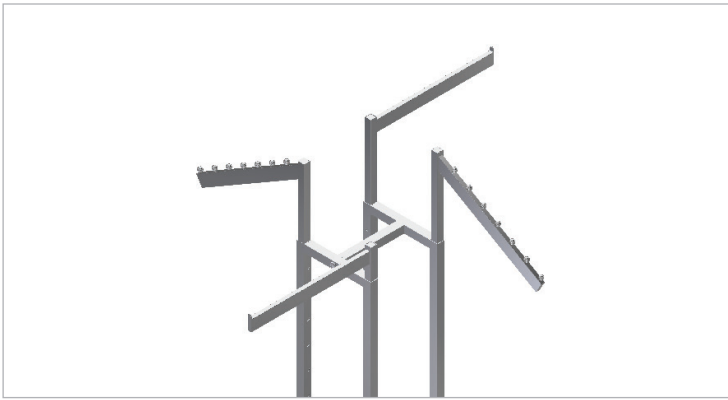

0400

Two straight arms and two slant arms with balls - rectangular tubing.



0401

Four straight arms - rectangular tubing.

0402

Four slant arms with balls - rectangular tubing.

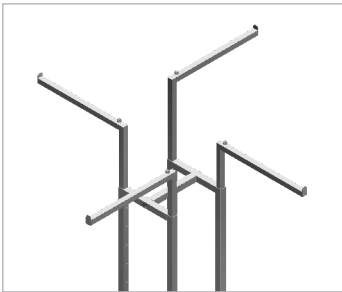

0403

Four straight arms - square tubing.

0404

Two straight arms and two slant arms with balls - square tubing.



0405

Four slant arms with balls - square tubing.

0406

Four slant arms with hooks - square tubing.



0408

Topper for four way rack.

Note: Base of 1" square tubing with levelers. Available finish: chrome. Arms are adjustable every 3" from 48" to 72". Special colours are available upon request.

0500

Two 16" straight arms & two 16" slant arms with balls - rectangular tubing.

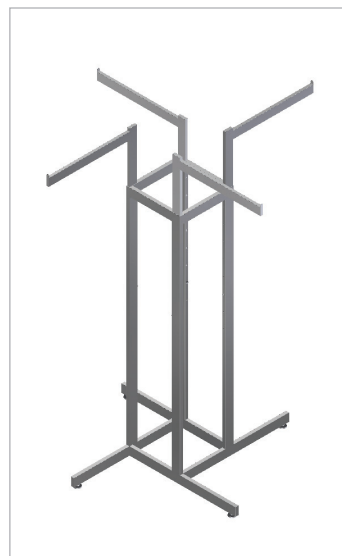
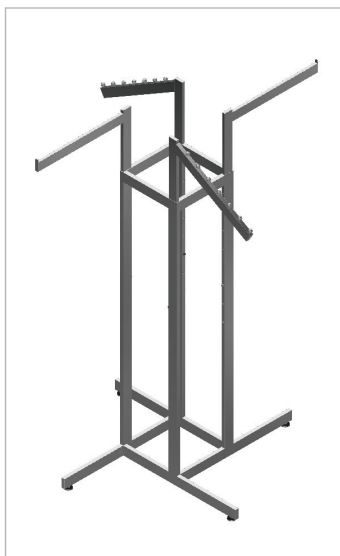

0501

Four 16" straight arms - rectangular tubing.

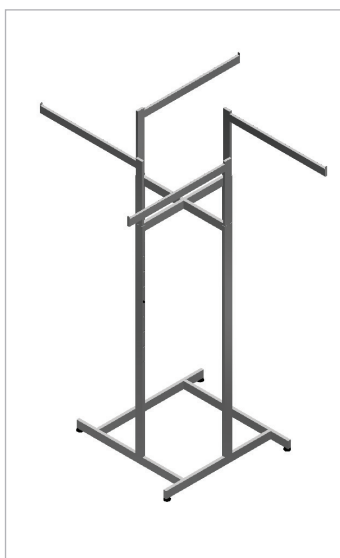

0504

Four 22" straight arms - rectangular tubing.

0505

Two 22" straight arms and two 22" slant arms with balls - rectangular tubing.

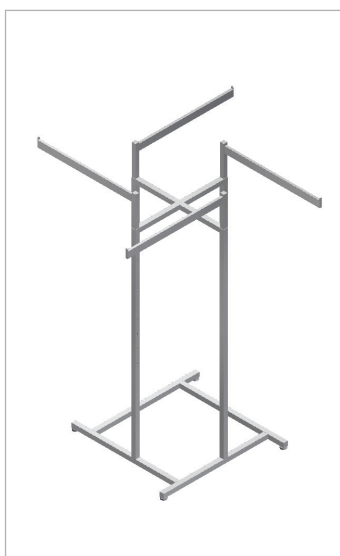

0506

Four 22" straight arms - rectangular tubing.

0507

Four 22" slant arms with balls - rectangular tubing.

Note: Base of 5/8" x 1-5/8" rectangular tubing with levelers. Available finish: chrome (exclude: #0506 and #0507 which is in 1" square tubing). Arms are adjustable every 3" from 48" to 72". Special colours are available upon request.

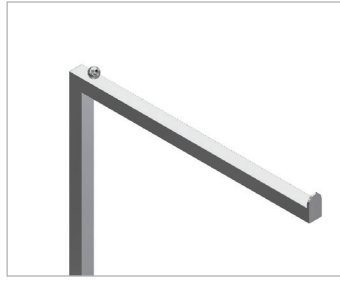
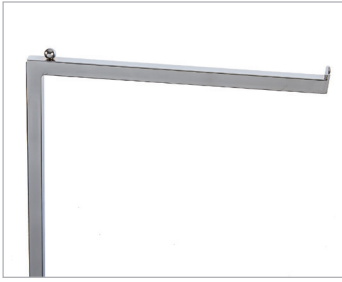

0600

16" straight arm - square tubing.

AVAILABLE FINISH: CHR ●

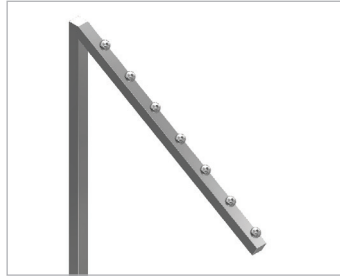
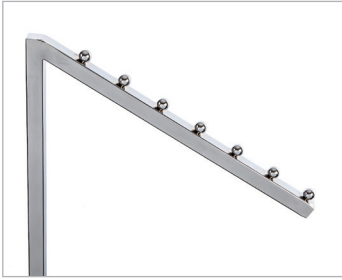

0601

16" slant arm with 7 balls - square tubing.

AVAILABLE FINISH: CHR ●

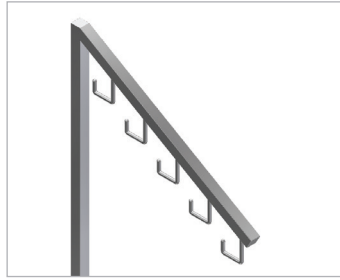
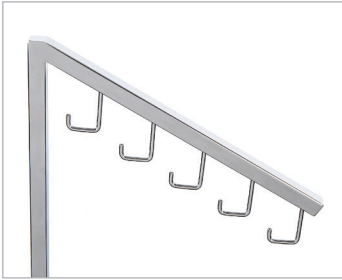

0602

16" slant arm with 5 hooks - square tubing.

AVAILABLE FINISH: CHR ●



0603

16" straight arm - rectangular tubing.

AVAILABLE FINISH: CHR ●

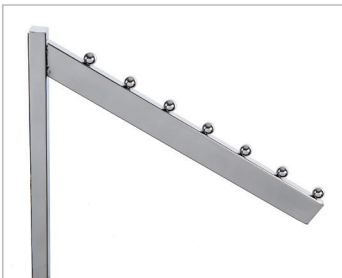

0604

16" slant arm with 7 balls - rectangular tubing.

AVAILABLE FINISH: CHR ●

0605

Bow arm with rectangular tubing.



AVAILABLE FINISH: CHR ●

0606-12

12" straight twist-on arm - square tubing.

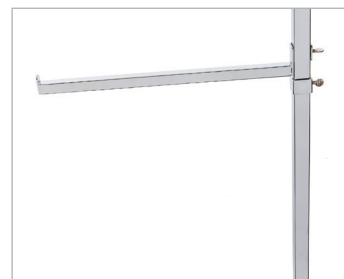
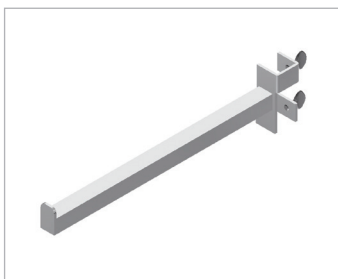

AVAILABLE FINISH: CHR ●

0606-16

16" straight twist-on arm - square tubing.

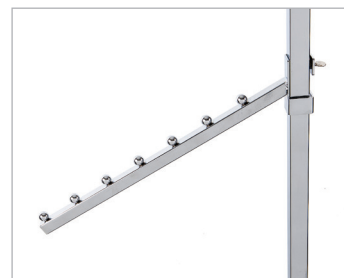

AVAILABLE FINISH: CHR ●

0607

16" slant twist-on arm with 7 balls - square tubing.

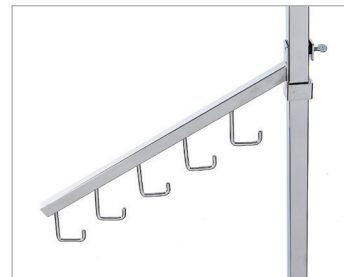
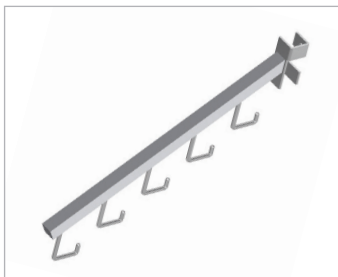

AVAILABLE FINISH: CHR ●

0608

16" slant twist-on arm with 5 hooks - square tubing.

AVAILABLE FINISH: CHR ●

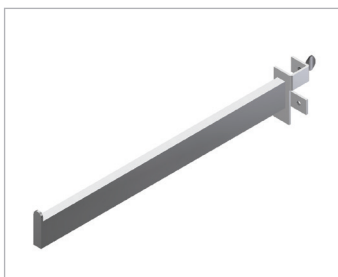

0609

12" straight twist-on arm - rectangular tubing.

0610

16" straight twist-on arm - rectangular tubing.

AVAILABLE FINISH: CHR ●

Note: Fits 1" square tubing uprights.



AVAILABLE FINISH: CHR ●

0700

36" diameter folding round rack with hangrail
1-1/4" diameter round tubing.

0701

42" diameter folding round rack with hangrail
1-1/4" diameter round tubing.



AVAILABLE FINISH: CHR ●

0702

36" diameter folding round rack with hangrail
1/2" x 1-1/2" rectangular tubing.

0703

42" diameter folding round rack with hangrail
1/2" x 1-1/2" rectangular tubing.



AVAILABLE FINISH: CHR ●

0704

36" add on hangrail - round tubing.

0705

42" add on hangrail - round tubing.

0706

36" add on hangrail - rectangular tubing.

Note: Base of 1" square tubing with levelers, legs are adjustable every 3" from 48" to 66" high. Racks will accept 5/16" threaded casters with 1" stem (sold separately).

0708

4 way topper for round racks.



AVAILABLE FINISH: CHR 

0709

30" grid topper, 3" lip (fits all #0700 series round racks).



AVAILABLE FINISH: CHR 

07-PINS

Glass shelf support for #0700 series round racks.



AVAILABLE FINISH: CHR 



0802

36" diameter tri-level rack.

0803

42" diameter tri-level rack.

AVAILABLE FINISH: CHR 

Note: Base and uprights of 1" x 2" rectangular tubing. Hangrails of 1/2" x 1-1/2" rectangular tubing, adjustable every 3" from 48" to 72".



0810-30

30" diameter collapsible revolving rack with 1" round tubing ring.

0810-36

36" diameter collapsible revolving rack with 1" round tubing ring.

0811-30

30" diameter collapsible revolving rack with 1/2" x 1-1/2" rectangular tubing ring.

0811-36

36" diameter collapsible revolving rack with 1/2" x 1-1/2" rectangular tubing ring.

AVAILABLE FINISH: CHR 

Note: Racks will accept 5/16" threaded casters with 1" stem (sold separately).

0900

60" hangrail of 1-1/4" diameter round tubing. Frame made of 1" square tubing, 22"W x 49"L with levelers. Arms height are adjustable every 3" from 48" to 72".



AVAILABLE FINISH: CHR 

0901

Same as #0900 with "Z" bar construction.



AVAILABLE FINISH: CHR 

0901-ZB

"Z" brace for #0900 rack.



AVAILABLE FINISH: CHR 

Note: Racks will accept 5/16" threaded casters with 1" stem (sold separately).



0902

Same as #0900 with "V" bar construction.

AVAILABLE FINISH: CHR ●



0903-48C

48" add-on hangrail for 2nd tier - separate clamps.

0903-60C

60" add-on hangrail for 2nd tier - separate clamps.

0903(A)-60

60" add-on hangrail for 2nd tier - welded clamps.

AVAILABLE FINISH: CHR ●

Note: Racks will accept 5/16" threaded casters with 1" stem (sold separately).

0904-24C

24" add-on hangrail for #0900.

0904-36C

36" add-on hangrail for #0900.

0904-48C

48" add-on hangrail for #0900.

0904-60C

60" add-on hangrail for #0900.

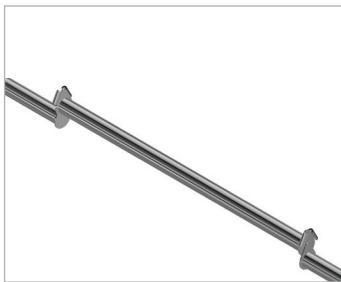

AVAILABLE FINISH: CHR 

0905

Grid basket, 60" x 24" for #0900 racks.

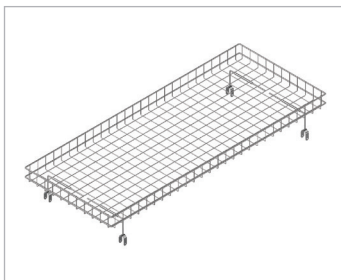

AVAILABLE FINISH: CHR 

0906

End gable twist-on bracket.

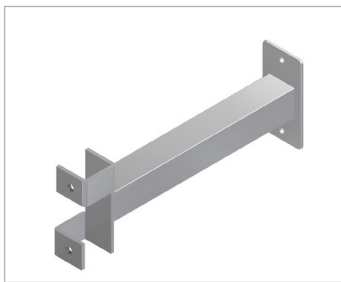

AVAILABLE FINISH: CHR 

0907

Hangrail connector.



AVAILABLE FINISH: CHR 

Note: Racks will accept 5/16" threaded casters with 1" stem (sold separately).



1002

Two tier handbag display. 1" square tubing base with levelers. Four 16" slant arms with 5 hooks and four 16" twist-on slant arm with 5 hooks.



1003

Spiral rack. 18" round base, 67" high with 29 balls. Threaded top for sign holder.

AVAILABLE FINISH: CHR ●



1004

Revolving belt rack. 18" round base, 52" high, 1" diameter upright and 18" ring with 20 hooks. Threaded top for sign holder.

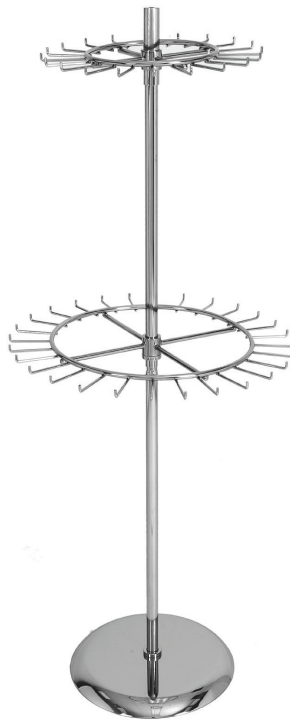

1005

Two tier revolving belt rack. 18" base, 60" high, 1-1/4" diameter upright. One 19" ring with 19 hooks and one 27" ring with 27 hooks. Threaded top for sign holder.

AVAILABLE FINISH: CHR ●

1006

Triple tier revolving belt rack. 18" base, 70" high, 1-1/4" diameter upright. Three 13" rings with 12 hooks. Threaded top for sign holder.

AVAILABLE FINISH: CHR 



1007

Revolving millinery tree. 18" base, 72" high, 1" diameter upright. Total of 12 arms with foam caps.

AVAILABLE FINISH: CHR 



1008

Folding lingerie tower. 1" square tubing frame with levelers and 16 twist-on arms.

AVAILABLE FINISH: CHR 





1100

Collapsible garment rack. 48" hangrail of 1" diameter round tubing with 12" pullout arm. Adjustable 55", 60" and 65" high. Casters included.

AVAILABLE FINISH: CHR 



1103B

"Z" rack with 60" hangrail and upright of 1-1/4" diameter round tubing. Base of 1-1/2" square tubing in epoxy black finish. Rack is 69" high, 22" wide with four rubber casters.

AVAILABLE FINISH: CHR 

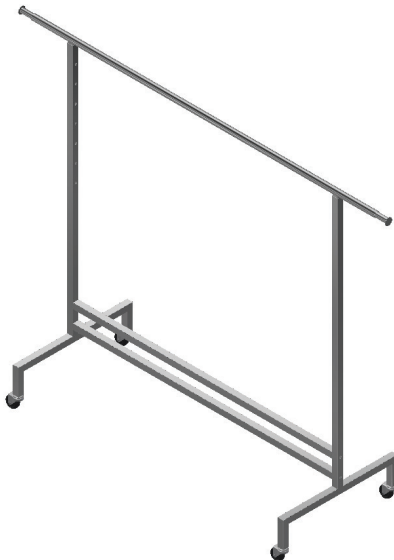

1105

Single hangrail rolling rack. 1" square tubing frame, 20" wide. 60" hangrail long hangrail adjustable from 54" to 74" high with 12" pullout arms. 3" rubber casters included.

AVAILABLE FINISH: CHR 

VAL1105R

Single hangrail rolling rack. 60"L x 22"W x 60"H with casters.

AVAILABLE FINISH: CHR 



1126

Double collapsible garment rack.

AVAILABLE FINISH: CHR 



1115

12" height extension for #1103B "Z" rack.



AVAILABLE FINISH: CHR 

1116

60" add-on hangrail for #1103B "Z" rack.

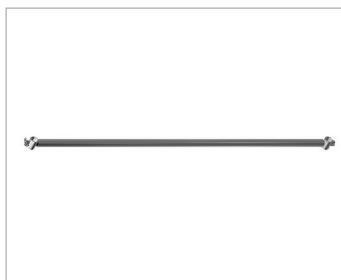

AVAILABLE FINISH: BLK 



1107B-W/L / 1107B

Twin wheel caster 3/8" - 16 threading, black hood with lock / without lock.

1108B-W/L / 1108B

Twin wheel caster 5/16" - 18 threading, black hood with lock / without lock.

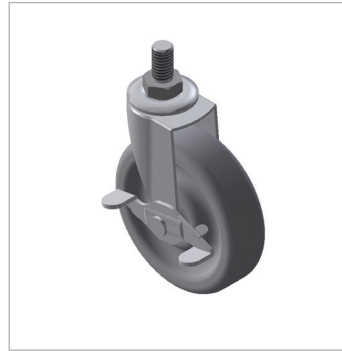

1109 / 1110

3" industrial bearing caster, 3/8" - 16 threading with lock / without lock.

1113 / 1114

3" industrial bearing caster, 5/16" - 18 threading with lock / without lock.



1117 / 1118

4" industrial bearing caster, 1/2" - 13 threading with lock / without lock.



1111

Shepherd caster, 3/8" - 16 threading.

1112

Shepherd caster, 5/16" - 18 threading.

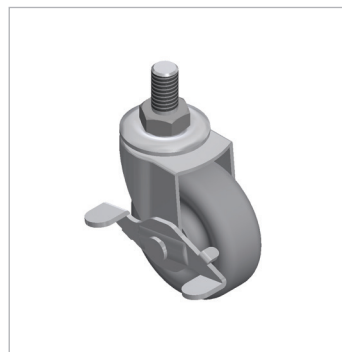

1122 / 1123

2" industrial bearing caster, 5/16" - 18 threading with lock / without lock.

1124 / 1125

2" industrial bearing caster, 3/8" - 16 threading with lock / without lock.

1202

Double sided shoe rack with ten 48"L x 10"W wire shelves.

AVAILABLE FINISH: CHR ●

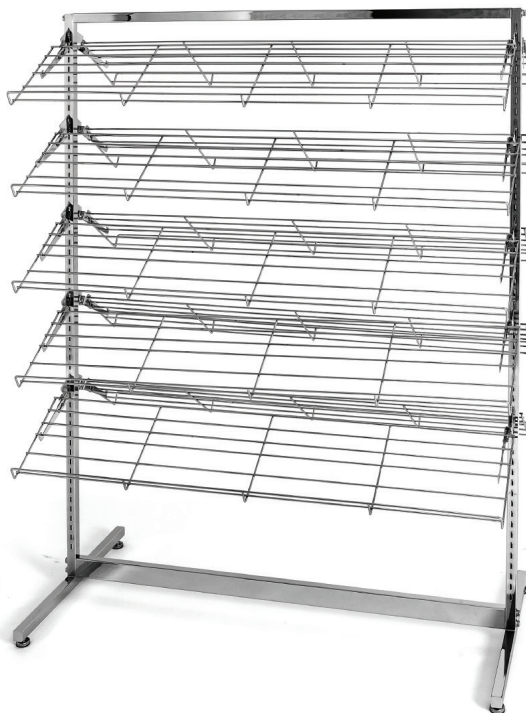

1203

Heavy duty fitting stool with black vinyl seat.

AVAILABLE FINISH: CHR ●



1204

Slant shoe shelf for grid in 1/4" wire, 13"L x 4-1/4"W.

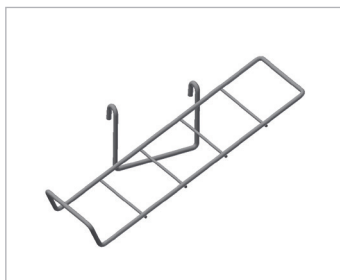

AVAILABLE FINISH: CHR ●

1205

Plexi shoe displayer with toe stop.

1206

Plexi shoe displayer with heel stop.





1207

Plexi riser set 3", 4" & 5" high.

1208

Plexi riser set 4", 6" & 8" high.

1221

3 pieces set acrylic riser 4"W.

1222

3 pieces set acrylic riser 6"W.

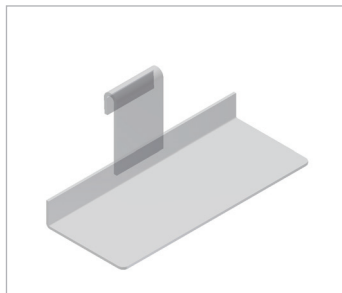

1209

Plexi shoe shelf for grid, 10"L x 4"W.



1212

Plexi shoe shelf for slatwall, 10"L x 3"W.

1213

Plexi shoe shelf for slatwall, 10"L x 4"W.

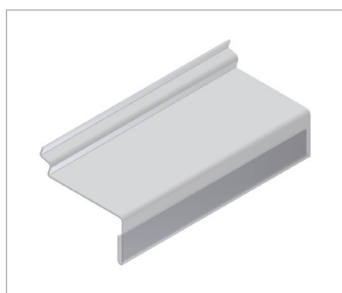

1214

Plexi shoe shelf for slatwall with 2" sign lip, 10"L x 4"W.

1215

Right slant plexi shoe shelf for slatwall, 9"L x 4"W.

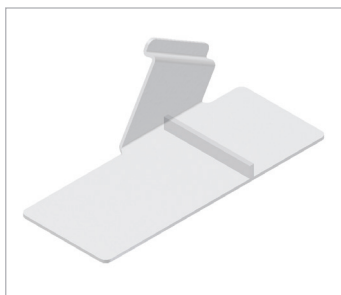

1216

Left slant plexi shoe shelf for slatwall, 9"L x 4"W.

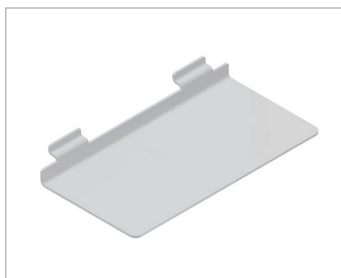

1217

12" x 6" plexi shoe shelf for slatwall, 3/16" thickness.

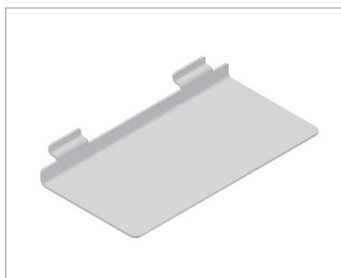

1220

12" x 18" acrylic floor mirror.

1228

12" x 18" floor mirror with chrome metal frame.



1226

Shoe pod with 6" stem and 5" square base.

1227

Shoe pod with 10" stem and 5" square base.

AVAILABLE FINISH: CHR 

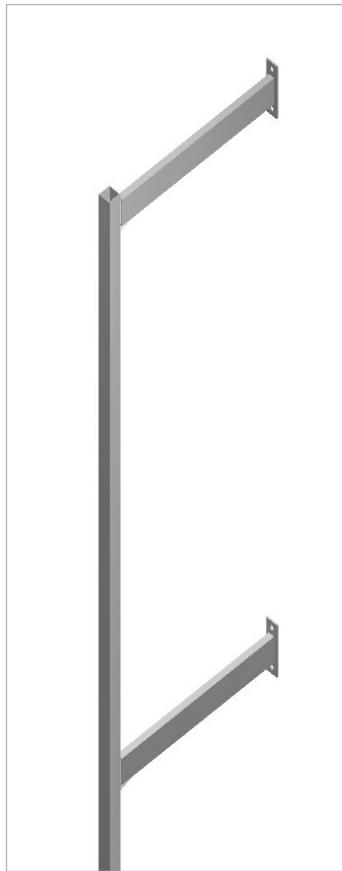

1301

Upright of 1" square tubing with 1/2" slot, 1" OC, 84" high with two 14" wall mount arms.

1301-96

Upright of 1" square tubing with 1/2" slot, 1" OC, 96" high with three 14" wall mount arms.

AVAILABLE FINISH: CHR ●

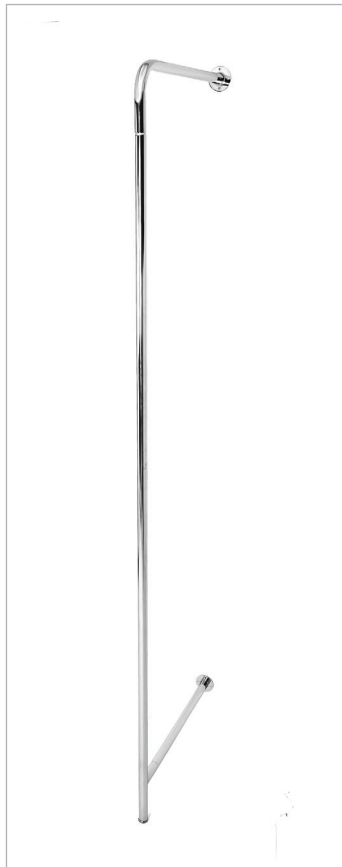

1302

Upright of 1" x 2" rectangular tubing with 1/2" slot, 1" OC, 90" high with one 15" wall mount arm.

1303

Upright of 1-1/4" diameter round tubing with 1/2" slot, 1" OC, 96" high with one 24" wall mount arm.

AVAILABLE FINISH: CHR ●

1400

General duty single slot wall standard, 1/2" slot, 1" OC (holes 9" apart). Available in 24", 36", 48", 60", 72", 84", 96", 120" and 144" length (24" available in chrome finish only).

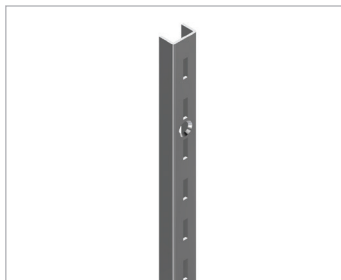

AVAILABLE FINISHES: CHR ☐ ZNC ☒

1401

General duty twin slot wall standard, 1/2" slot, 1" OC (holes 6" apart). Available in 36", 48", 60", 72", 84" and 96" length.

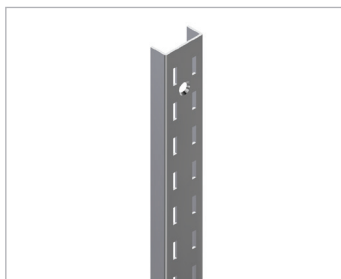

AVAILABLE FINISHES: CHR ☐ ZNC ☒

1402

Extra heavy duty single slot wall standard, 1" slot, 2" OC (holes 9" apart). Available in 72", 84", 96" and 120" length.

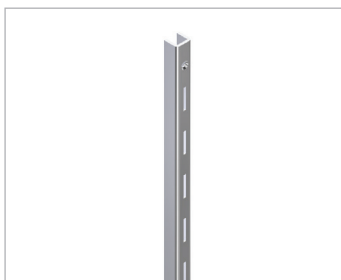

AVAILABLE FINISHES: CHR ☐ ZNC ☒

1403

Heavy duty single slot wall standard, 1/2" slot, 1" OC (holes 9" apart). Available in 48", 60", 72", 84", 96", 120", 144" length.

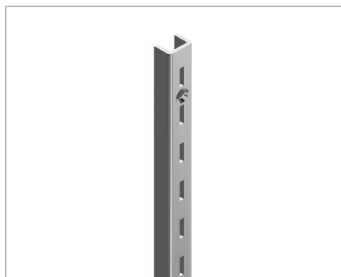

AVAILABLE FINISHES: CHR ☐ ZNC ☒

1404

Heavy duty twin slot wall standard, 1/2" slot, 1" OC (holes 6" apart). Available in 48", 60", 72", 84", 96", 120", 144" length.

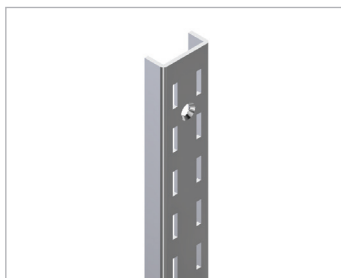

AVAILABLE FINISHES: CHR ☐ ZNC ☒

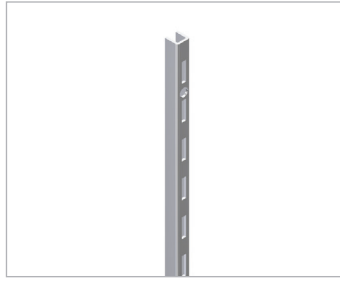

1405

General duty single slot mini wall standard. 1/2" slot, 1" OC. Available in 48", 60", 72" and 96" length.

AVAILABLE FINISHES: CHR ☐ ZNC ☒

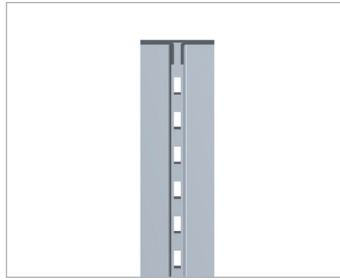

1409

Recessed wall standard, 1/2" slot. 1" OC. Available in 96" and 120" length.

AVAILABLE FINISH: ZNC ☒

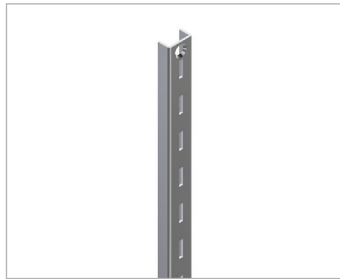

1411

General duty single slot wall standard 1/2" slot, 1" OC (holes 6" apart). Available in 24", 36", 48", 60", 72", 84" and 96" length.

AVAILABLE FINISHES: CHR ☐ ZNC ☒

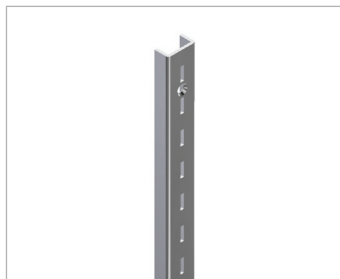

1412

Heavy duty single slot wall standard, 1" OC (holes 6" apart). Available in 48", 60", 72", 96" and 120" length.

AVAILABLE FINISHES: CHR ☐ ZNC ☒

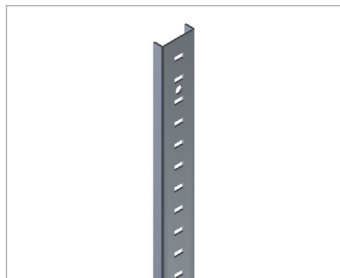

1420

72" Pilaster.

AVAILABLE FINISH: ZNC ☒

1441

Heavy duty wide slot wall standard, 1" slot, 2" OC. Available in 96" and 120" length.

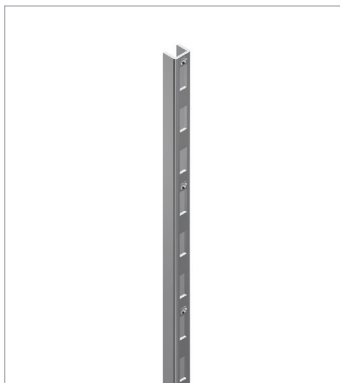

AVAILABLE FINISHES: CHR ● SAT ● CHR ● RAW ●

1442

Heavy duty wide slot recessed wall standard. 1" slot, 2" OC. Available in 120" length.

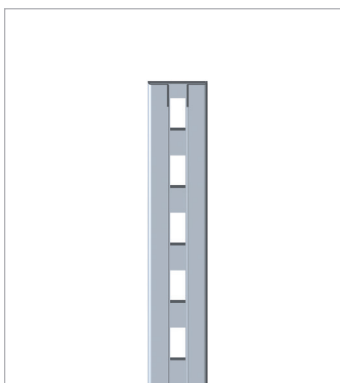

AVAILABLE FINISH: ZNC ●

1406

Top cap for single slot wall standard (#1400 and 1403 series).

1413Z

Top cap for single slot wall standard (#1411 series).



AVAILABLE FINISH: ZNC ●

1407

Bottom cap for single slot wall standard (#1400 and #1403 series).

1414Z

Bottom cap for single slot wall standard (#1411 series).

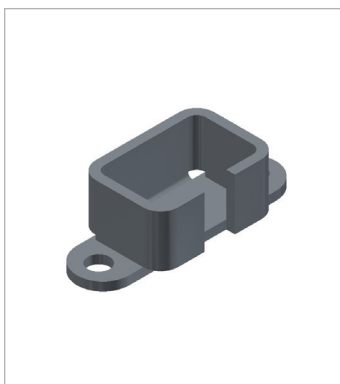

AVAILABLE FINISH: ZNC ●

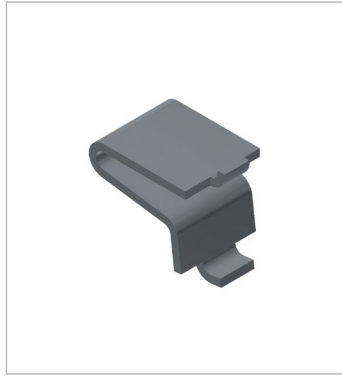
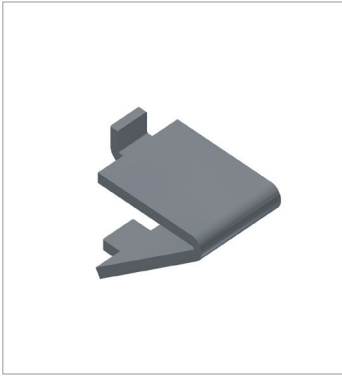

1424Z

Light duty shelf support.

1425Z

Light duty shelf support.

AVAILABLE FINISH: ZNC ●

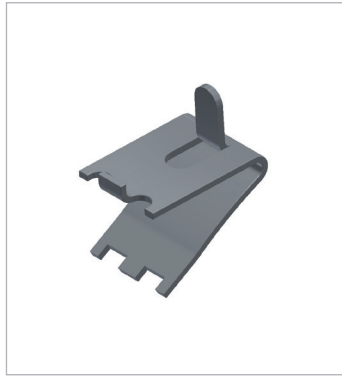

1426Z

Heavy duty shelf support.

1427Z

Heavy duty shelf support.

AVAILABLE FINISH: ZNC ●

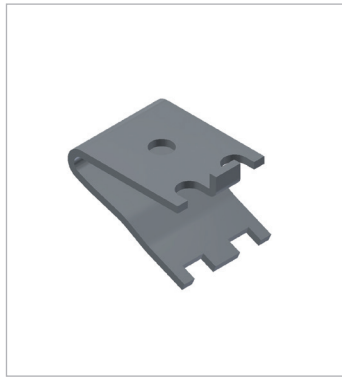

1428Z

Heavy duty shelf support.

1429Z

Light duty shelf support (cushion excluded).

AVAILABLE FINISH: ZNC ●

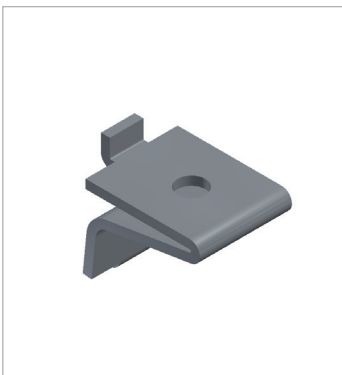

1430Z

Heavy duty shelf support (cushion excluded).

AVAILABLE FINISH: ZNC ●

1500

General duty bracket with end tip. Available sizes: 4", 6", 8", 10", 12", 14", 16" and 18" (fits 1/2" slot, 1" OC wall standards. Will not fit recessed wall standards).

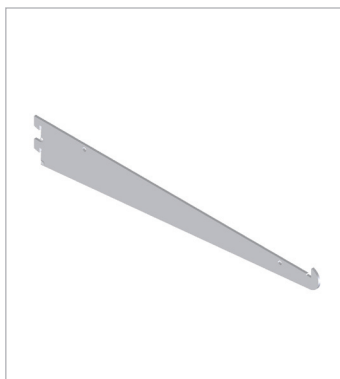

AVAILABLE FINISHES: CHR ☐ ZNC ☒

1501

General duty wood shelf bracket with two lugs, sold in pairs. Available sizes: 4", 6", 8", 10", 12", 14" and 16" (fits 1/2" slot, 1" OC wall standards. Will not fit recessed wall standards).



AVAILABLE FINISH: ZNC ☒

1502

Showcase bracket with locking nut. Available sizes: 8", 10", 12", 14" and 16" (fits 1/2" slot, 1" OC wall standards).



AVAILABLE FINISH: CHR ☒

1507

Adjustable shelf bracket with end tip. Adjustable in 15 degrees upswing from 90 degree down to 15, 30 and 45 degrees. Available sizes: 8", 10", 12", 14" and 16" (fits 1/2" slot, 1" OC wall standards. Will not fit recessed wall standards).

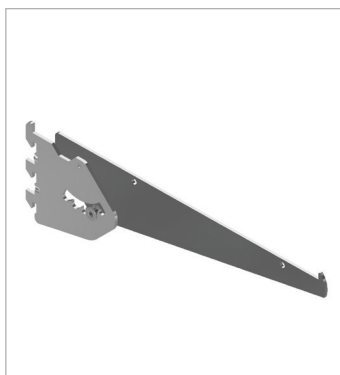

AVAILABLE FINISH: CHR ☒

**1508**

Adjustable wood shelf bracket with two lugs, sold in pairs. Adjustable in 15 degrees upswing from 90 degree down to 15, 30 and 45 degrees. Available sizes: 8", 10", 12", 14" and 16" (fits 1/2" slot, 1" OC wall standards. Will not fit recessed wall standards).

AVAILABLE FINISH: ZNC ●

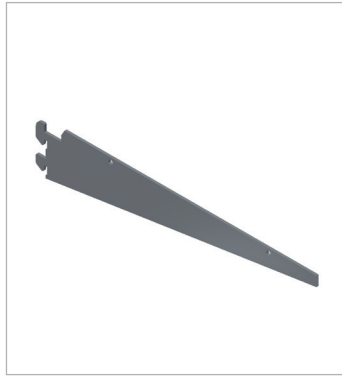
**1509**

General duty shelf bracket. Available sizes: 8", 10", 12", 14", 16" and 18" (fits 1/2" slot, 1" OC wall standards).

AVAILABLE FINISH: ZNC ●

**1510**

Showcase bracket. Available sizes: 8", 10", 12", 14" and 16" (fits 1/2" slot, 1" OC wall standards).

AVAILABLE FINISH: CHR ●

**1513**

Heavy duty wood shelf brackets, sold in pairs. Available sizes: 8", 10", 12", 14", 16", 18", 20", 22" and 24" (fits 1/2" slot, 1" OC wall standards).

AVAILABLE FINISH: ZNC ●

1600

Bracket for use with #2012 "U" cup. Available sizes: 10", 12" and 14" (fits 1/2" slot, 1" OC wall standards).

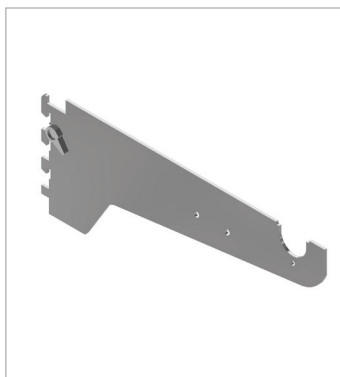

AVAILABLE FINISH: CHR ●

1601

Bracket for use with #2013 "U" cup. Available sizes: 10", 12" and 14" (fits 1/2" slot, 1" OC wall standards).



AVAILABLE FINISH: CHR ●

1602

12" bracket for use with #1906, #2014 and #2015 snap on attachment (fits 1/2" slot, 1" OC wall standards).

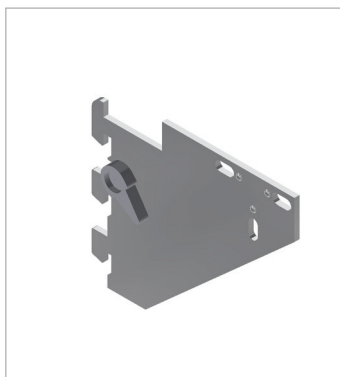

AVAILABLE FINISH: CHR ●

1603

14" bracket for use with #1906, #2014 and #2015 snap on attachment (fits 1/2" slot, 1" OC wall standards).



AVAILABLE FINISH: CHR ●

1606

3" bracket for use with #1906, #2014 and #2015 snap on attachment (fits 1/2" slot, 1" OC wall standards).



AVAILABLE FINISH: CHR ●

1607

Heavy duty twin bracket with "U" cup for 1" or 1-1/16" round hangrail. Available sizes: 8", 10", 12", 14" and 16" (fits 1/2" slot, 1" OC wall standards).

1608

Heavy duty twin bracket with "U" cup for 1-1/4" or 1-5/16" round hangrail. Available sizes: 8", 10", 12", 14" and 16" (fits 1/2" slot, 1" OC wall standards).



1609

12" bracket for 1" or 1-1/16" round tube (fits 1/2" slot, 1" OC wall standards).

1610

12" bracket for 1-1/4" or 1-5/16" round tube (fits 1/2" slot, 1" OC wall standards).

AVAILABLE FINISH: CHR 



1612

14" wall mount bracket for outrigger. Made of 1/2" x 1-1/2" rectangular tubing (fits 1/2" slot, 1" OC wall standards).

AVAILABLE FINISH: CHR 



1613

Rear mount bracket for 1" or 1-1/16" round tube (fits 1/2" slot, 1" OC wall standards).

1614

Rear mount bracket for 1-1/4" or 1-5/16" round tube (fits 1/2" slot, 1" OC wall standards).

AVAILABLE FINISH: CHR 



1615

Side mount bracket for 1" or 1-1/16" round tube (fits 1/2" slot, 1" OC wall standards).

1616

Side mount bracket for 1-1/4" or 1-5/16" round tube (fits 1/2" slot, 1" OC wall standards).

AVAILABLE FINISH: CHR 

1700

16" waterfall in 1/2" x 1-1/2" rectangular tubing with 7 balls (fits 1/2" slot, 1" OC wall standards).

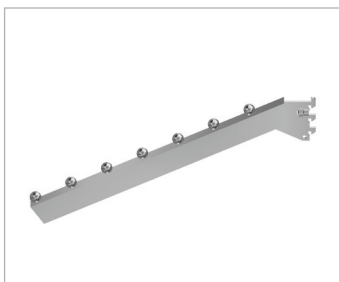

AVAILABLE FINISH: CHR ☐

1701

12" straight faceout in 1/2" x 1-1/2" rectangular tubing (fits 1/2" slot, 1" OC wall standards).



AVAILABLE FINISHES: CHR ☐ SAT CHR ☐

1702

16" waterfall in 1/2" x 1-1/2" rectangular tubing with 5 hooks (fits 1/2" slot, 1" OC wall standards).

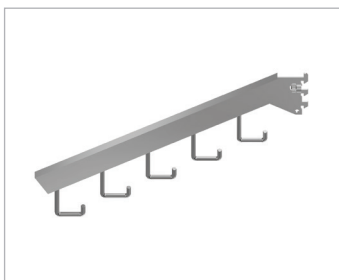

AVAILABLE FINISH: CHR ☐

1703

18" waterfall in 3/4" square tubing with 7 balls (fits 1/2" slot, 1" OC wall standards).

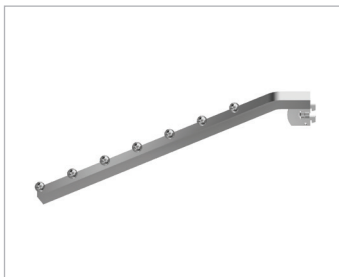

AVAILABLE FINISH: CHR ☐

1704

12" straight faceout in 3/4" square tubing (fits 1/2" slot, 1" OC wall standards).



AVAILABLE FINISHES: CHR ☐ SAT CHR ☐

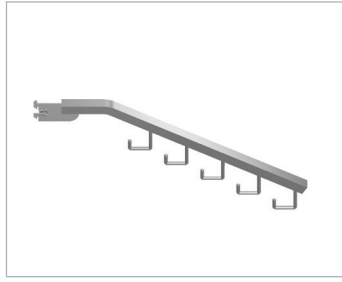
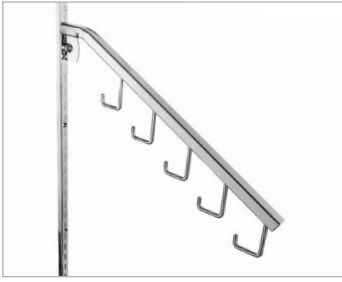

1705

18" waterfall in 3/4" square tubing with 5 hooks (fits 1/2" slot, 1" OC wall standards).

AVAILABLE FINISHES: CHR ● SAT CHR ●

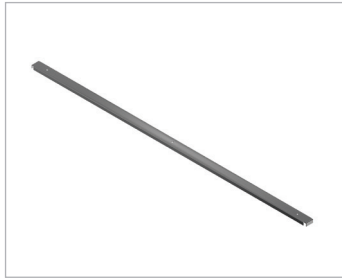

1706

Glass shelf support for brackets. Available sizes: 24", 30" 36" and 48" (fits 1/2" slot, 1" OC wall standards).

AVAILABLE FINISH: CHR ●

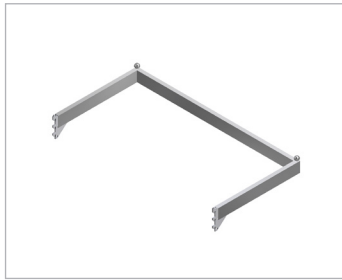

1707

"U" hangrail of 1/2" x 1-1/2" rectangular tubing. Available sizes: 24", 36" and 48" (fits 1/2" slot, 1" OC wall standards).

AVAILABLE FINISH: CHR ●



1708

Straight crossbar of 1/2" x 1-1/2" rectangular tubing. Available sizes: 24", 36" and 48" (fits 1/2" slot, 1" OC wall standards).

AVAILABLE FINISH: CHR ●



1720

"U" hangrail of 1/2" x 1-1/2" rectangular tubing. Available sizes: 24", 36" and 48" (fits 1" slot, 2" OC wall standards).

AVAILABLE FINISHES: CHR ● SAT CHR ● RAW ●

1721

Straight crossbar of 1/2" x 1-1/2" rectangular tubing. Available sizes: 24", 36" and 48" (fits 1" slot, 2" OC wall standards).

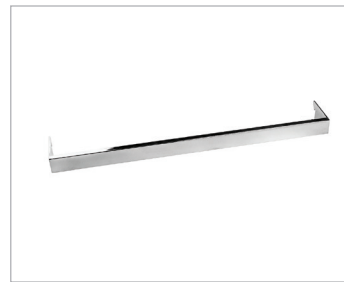

AVAILABLE FINISHES: CHR ☐ SAT CHR ☒ RAW ☐

1709

Heavy duty center shelf rest.



AVAILABLE FINISH: ZNC ☒

1710

Heavy duty front shelf rest.

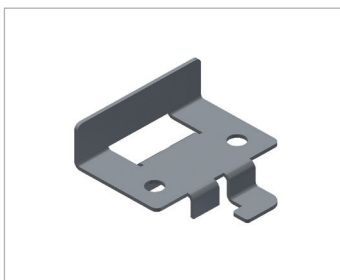

AVAILABLE FINISH: ZNC ☒

1711

Heavy duty left shelf rest.

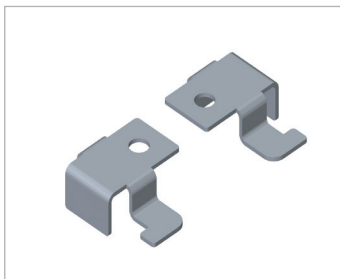

AVAILABLE FINISH: ZNC ☒

1712

Heavy duty right shelf rest.

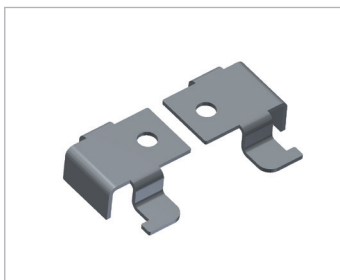

AVAILABLE FINISH: ZNC ☒

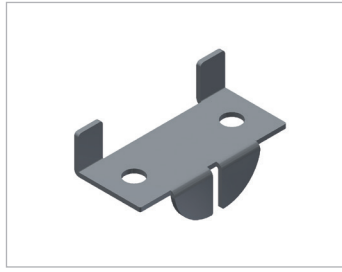

1713

General duty front shelf rest.

AVAILABLE FINISH: ZNC ●

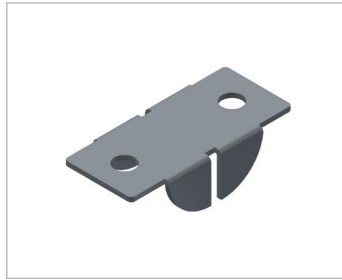

1714

General duty center shelf rest.

AVAILABLE FINISH: ZNC ●

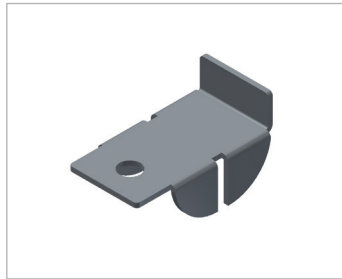

1715

General duty end shelf rest.

AVAILABLE FINISH: ZNC ●

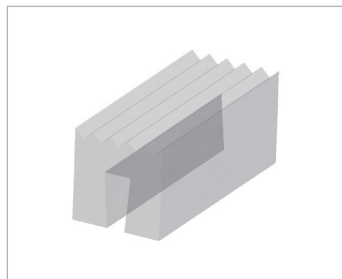

1716

Rubber cushion for knife bracket - grey.

1718

Rubber cushion for knife bracket - clear.

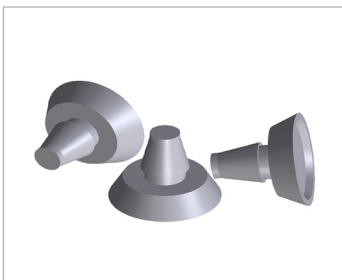

1717

Rubber rest cushion - grey.

1719

Rubber rest cushion - clear.

1800

Straight faceout for crossbar, in 1/2" x 1-1/2" rectangular tubing. Available sizes: 4", 6", 8", 10" and 12".

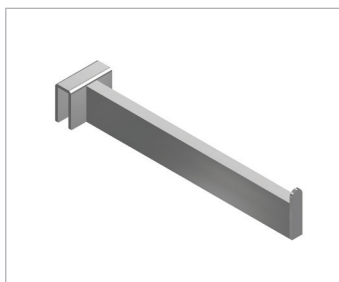

AVAILABLE FINISHES: CHR ☐ SAT CHR ☐

1801-16C

16" straight faceout for crossbar in 1/2" x 1-1/2" rectangular tubing.



AVAILABLE FINISHES: CHR ☐ SAT CHR ☐

1800-1003C

10" x 3" offset faceout in 1/2" x 1-1/2" rectangular tubing.



AVAILABLE FINISHES: CHR ☐ SAT CHR ☐

1802

16" crossbar waterfall with 7 balls in 1/2" x 1-1/2" rectangular tubing.



AVAILABLE FINISHES: CHR ☐ SAT CHR ☐

1803

16" crossbar waterfall with 5 hooks in 1/2" x 1-1/2" rectangular tubing.

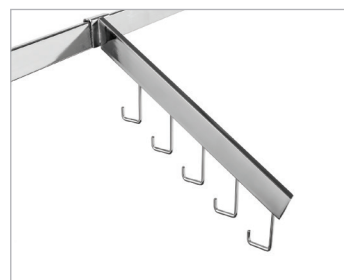

AVAILABLE FINISH: CHR ☐

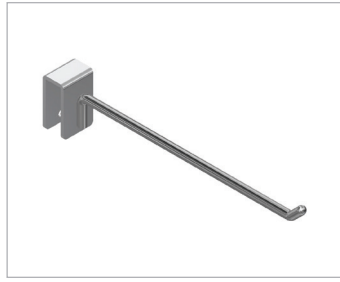

1804

1/4" wire hooks for crossbar. Available sizes: 4", 6", 8", 10" and 12".

AVAILABLE FINISHES: CHR ☐ SAT CHR ☐

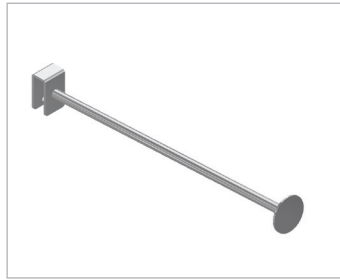

1805

12" heavy duty peg for crossbar. Made of 3/8" diameter rod with 1-3/4" diameter end disc.

AVAILABLE FINISH: CHR ☐

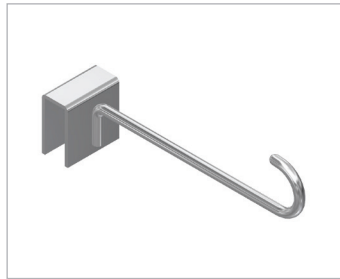

1815

1/4" wire safety hooks for crossbar. Available sizes: 4", 6", 8", 10" and 12".

AVAILABLE FINISHES: CHR ☐ SAT CHR ☐

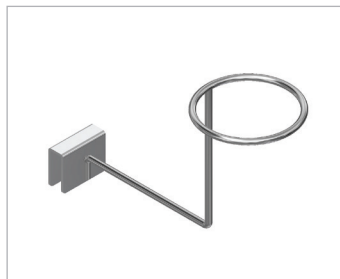
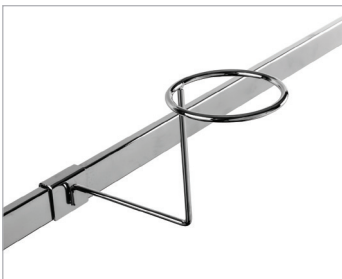

1816

Wire hat display for crossbar.

AVAILABLE FINISH: CHR ☐

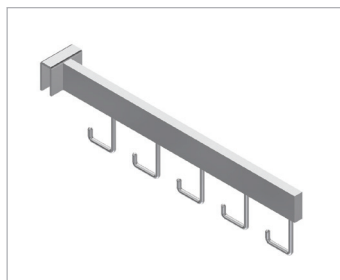
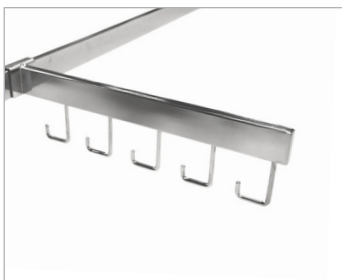

1817

5 hooks straight faceout for crossbar.

AVAILABLE FINISH: CHR ☐

1806

3" wall mount fitting room hook.



AVAILABLE FINISHES: CHR ☐ SAT CHR ☐

1807

6" wall mount fitting room hook.



AVAILABLE FINISHES: CHR ☐ SAT CHR ☐

1808

12" wall mount straight faceout in 1/2" x 1-1/2" rectangular tubing.

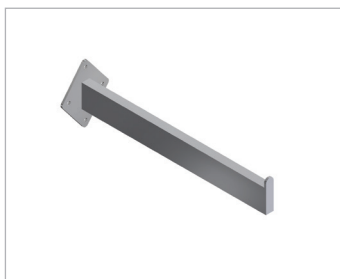

AVAILABLE FINISH: CHR ☐

1809

16" wall mount straight faceout in 1/2" x 1-1/2" rectangular tubing.



AVAILABLE FINISH: CHR ☐

1810

16" wall mount waterfall with 7 balls in 1/2" x 1-1/2" rectangular tubing.



AVAILABLE FINISH: CHR ☐

1811

16" wall mount waterfall with 5 hooks in 1/2" x 1-1/2" rectangular tubing.



AVAILABLE FINISH: CHR ☐

1812

12" wall mount straight faceout in 3/4" square tubing.



AVAILABLE FINISH: CHR ☐

1813

18" wall mount waterfall with 7 balls in 3/4" square tubing.



AVAILABLE FINISH: CHR ☐

1814

18" wall mount waterfall with 5 hooks in 3/4" square tubing.



AVAILABLE FINISH: CHR ☐

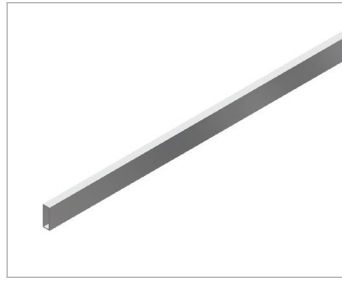

1900

Rectangular hangrail in 1/2" x 1-1/2" tubing.
Available sizes: 24", 36", 48", 60", 72", 96", 120" and 144".

AVAILABLE FINISHES: CHR ☐ SAT CHR ☐

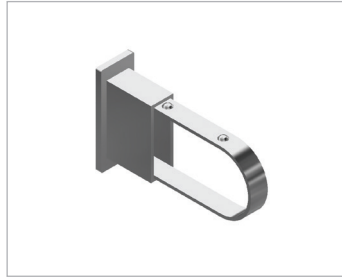

1902

Steel end cap with extension.

AVAILABLE FINISH: CHR ☐



1903

Steel end cap.

AVAILABLE FINISHES: CHR ☐ SAT CHR ☐



1904

Rectangular hangrail slicer.

AVAILABLE FINISH: ZNC ☐

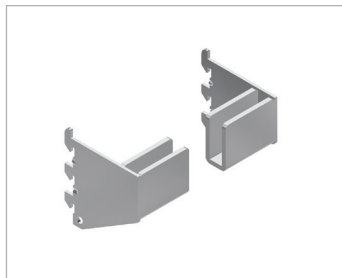

1905

2-1/2" end bracket for rectangular hangrail,
sold in pairs (fits 1/2" slot, 1" OC wall
standards).

AVAILABLE FINISH: CHR ☐

1906

Snap on socket for 1/2" x 1-1/2" rectangular hangrail (fits #1602, #1603, #1606, #1908 and #1909 brackets).



AVAILABLE FINISH: CHR ☐

1908

12" hangrail bracket for snap on attachment (fits 1" slot, 2" OC wall standards).



AVAILABLE FINISHES: CHR ☐ ZNC ☐

1909

14" hangrail bracket for snap on attachment (fits 1" slot, 2" OC wall standards).

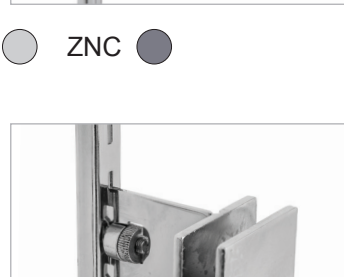
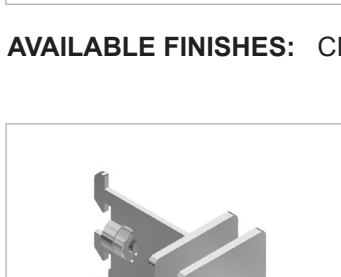

AVAILABLE FINISHES: CHR ☐ SAT CHR ☐

1910

2" bracket for rectangular hangrail (fits 1/2" slot, 1" OC wall standards).

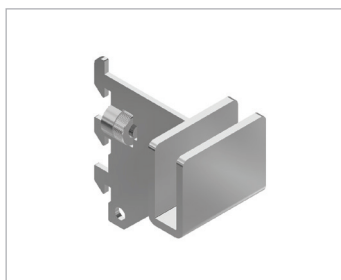

1912

3-3/8" bracket for rectangular hangrail (fits 1" slot, 2" OC wall standards).

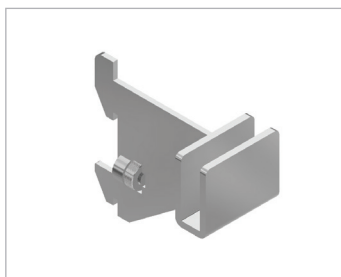

AVAILABLE FINISHES: CHR ☐ SAT CHR ☐

1913

12" bracket for rectangular hangrail (fits 1/2" slot, 1" OC wall standards).

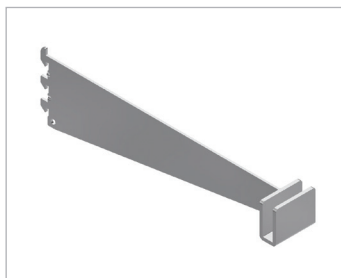

AVAILABLE FINISH: CHR ☐

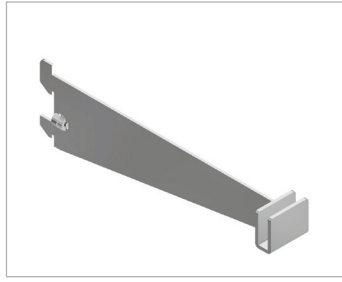

AVAILABLE FINISH: CHR ●

1914

12" bracket for rectangular hangrail (fits 1" slot, 2" OC wall standards).

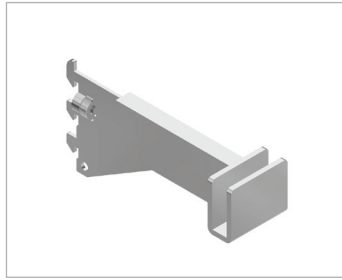

AVAILABLE FINISHES: CHR ● SAT CHR ●

1915

12" bracket for rectangular hangrail in 1/2" x 1-1/2" rectangular tubing (fits 1/2" slot, 1" OC wall standards).

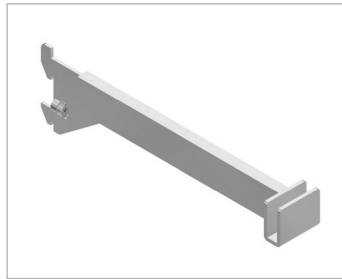

AVAILABLE FINISHES: CHR ● SAT CHR ●

1915-6

6" bracket for rectangular hangrail in 1/2" x 1-1/2" rectangular tubing (fits 1/2" slot, 1" OC wall standards).

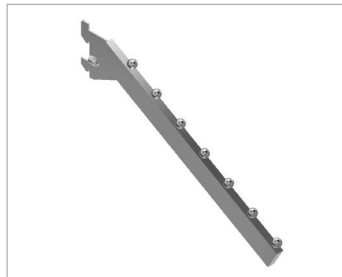

AVAILABLE FINISH: CHR ●

1916

12" bracket for rectangular hangrail in 1/2" x 1-1/2" rectangular tubing (fits 1" slot, 2" OC wall standards).

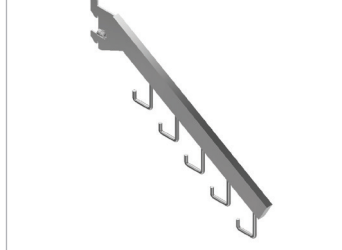

AVAILABLE FINISH: CHR ●

1917

16" waterfall with 7 balls in 1/2" x 1-1/2" rectangular tubing (fits 1" slot, 2" OC wall standards).

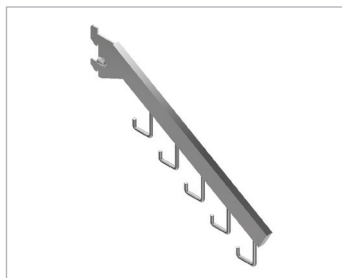

AVAILABLE FINISH: CHR ●

1918

16" waterfall with 5 hooks in 1/2" x 1-1/2" rectangular tubing (fits 1" slot, 2" OC wall standards).

1919

12" straight faceout in 1/2" x 1-1/2" rectangular tubing (fits 1" slot, 2" OC wall standards).



AVAILABLE FINISH: CHR ●

1921

Heavy duty wood shelf bracket, sold in pairs. Available sizes: 10", 12", 14", 16" and 18" (fits 1" slot, 2" OC wall standards).



AVAILABLE FINISH: CHR ●

1922

Steel end cap with tip.



AVAILABLE FINISHES: CHR ● SAT CHR ●

1923

Side mount bracket for rectangular hangrail (fits 1/2" slot, 1" OC wall standards).

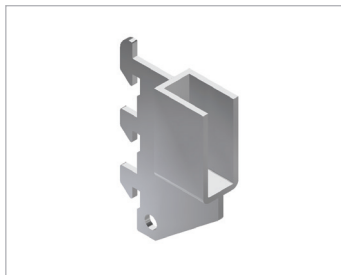

AVAILABLE FINISH: CHR ●

1924

12" end bracket for rectangular hangrail, sold in pairs (fits 1/2" slot, 1" OC wall standards).

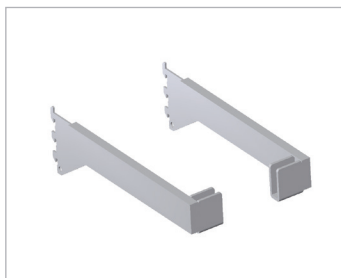

AVAILABLE FINISH: CHR ●



AVAILABLE FINISH: CHR ●

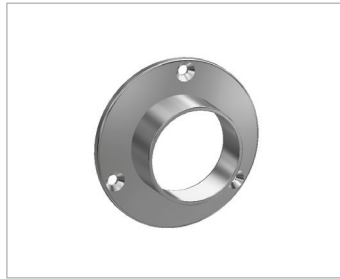
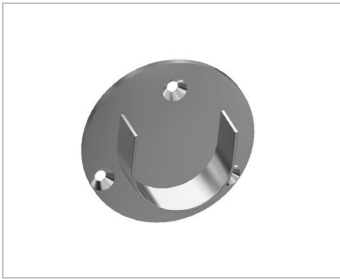

AVAILABLE FINISH: CHR ●



AVAILABLE FINISH: CHR ●



AVAILABLE FINISH: CHR ●

2000

1" diameter round tubing, 16 gauge. Available sizes: 48", 60", 72", 96", 120" and 144".

2001

1-1/16" diameter round tubing, 14 gauge. Available sizes: 48", 60", 72", 96", 120" and 144".

2002

1-1/4" diameter round tubing, 16 gauge. Available sizes: 48", 60", 72", 96", 120" and 144".

2003

1-5/16" diameter round tubing, 14 gauge. Available sizes: 96", 120" and 144".

2004

Open flange for 1-1/4" and 1-5/16" round tubing.

2005

Closed flange for 1-1/4" and 1-5/16" round tubing.

2006

Open flange for 1" and 1-1/16" round tubing.

2007

Closed flange for 1" and 1-1/16" round tubing.

2008

End cap for 1" and 1-1/16" round tubing.

2009

End cap for 1-1/4" and 1-5/16" round tubing.

2010

Splicer for 1" and 1-1/16" round tubing.



AVAILABLE FINISH: ZNC ●

2011

Splicer for 1-1/4" and 1-5/16" round tubing.



AVAILABLE FINISH: CHR ●

2012

"U" cup for 1" and 1-1/16" round tubing.

2013

"U" cup for 1-1/4" and 1-5/16" round tubing.



AVAILABLE FINISH: CHR ●

2014

Snap on spring clamp socket for 1" and 1-1/16" round tubing.

2015

Snap on spring clamp socket for 1-1/4" and 1-5/16" round tubing.



AVAILABLE FINISH: CHR ●

2016

Round domed end cap for 1" and 1-1/16" round tubing.

2016A

Round domed end cap for 1-1/4" and 1-5/16" round tubing.



AVAILABLE FINISH: CHR ●

2100

1" square tubing, 16 gauge. Available sizes: 48", 60" and 72".

2101

1" square tubing, 16 gauge. 2 side with 1/2" slot, 1" OC slotting. Available sizes: 96", 120" and 144".

2102

1" square tubing, 16 gauge. 4 side with 1/2" slot, 1" OC slotting. Available sizes: 96", 120" and 144".

2110

1" square tubing, 16 gauge. One side with 1/2" slot, 1" OC slotting. Available sizes: 96", 120" and 144".

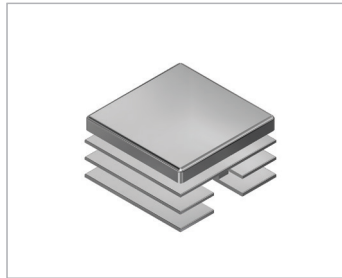

AVAILABLE FINISH: CHR ●

2106

Plastic chrome end cap for 1" square tubing.

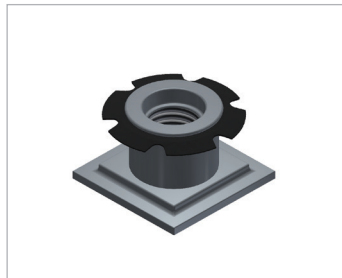

AVAILABLE FINISH: CHR ●

2107

Plug for sign stem 3/8" - 27 threading (fits 1" square tubing).

2108

Plug for leveler 3/8" - 16 threading (fits 1" square tubing).

2108-A

Plug for leveler 5/16" - 18 threading (fits 1" square tubing).

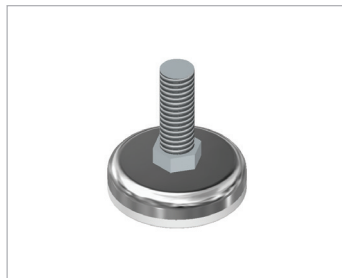

AVAILABLE FINISH: CHR ●

2109

Leveler 3/8" - 16 threading.

2109-A

Leveler 5/16" - 18 threading.

2200N

28" x 22" sign stand with 15" trumpet base, 67" high.



AVAILABLE FINISHES: CHR  BLK 

2201

28" x 22" sign stand with two 31" round uprights and 10" x 14" base, 59" high.



AVAILABLE FINISH: CHR 

2202

22" x 14" sign stand with two 7/8" square upright and 12" x 15" extra heavy base, 54" high.



AVAILABLE FINISH: CHR 

2203

28" x 22" sign stand with two 7/8" square upright and 12" x 15" extra heavy base, 60" high.



AVAILABLE FINISH: CHR ●

2205

28" x 22" sign stand with 1/2" x 1-1/2" rectangular tubing frame and 15" x 24" base, 56" high.



AVAILABLE FINISH: BLK ●

2233

Banner display with 1" square tube upright and 16" square flat base. Height adjustable from 54" to 96". Accepts notched or pocket style banners 48" to 84"H x 24"W.



AVAILABLE FINISHES: BLK ● CHR ●

2242

28" x 22" two-tier bulletin sign holder.

99-LOB-207

Three-tier bulletin stand.

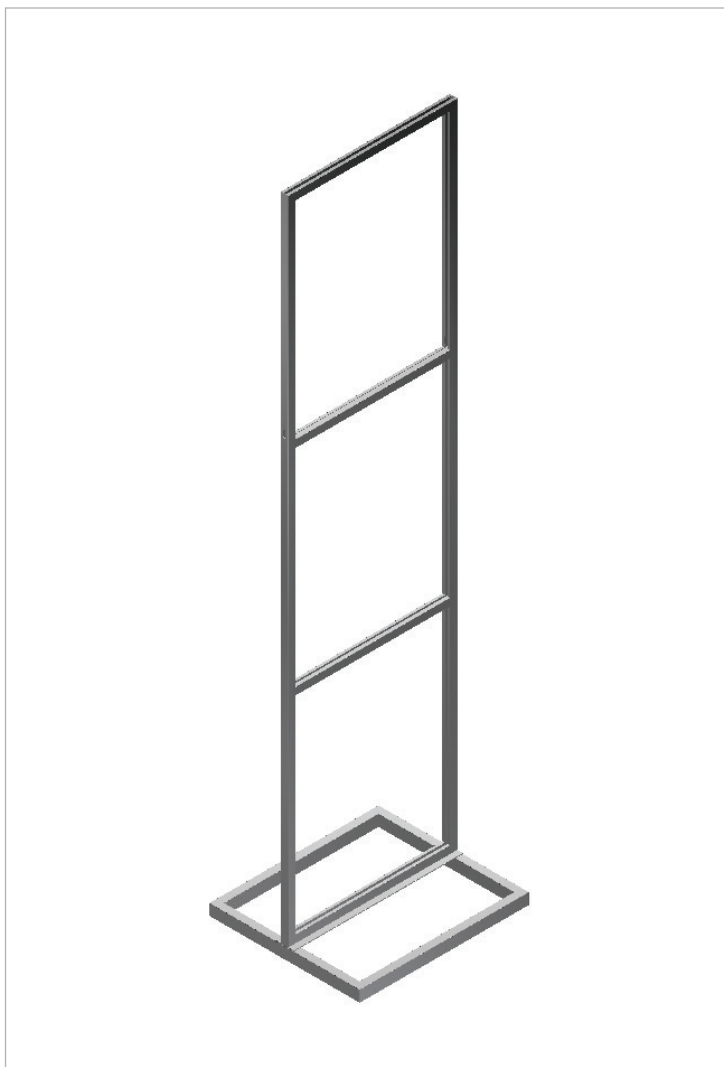

AVAILABLE FINISHES: BLK ● CHR ●

2240

Literature basket for 2200N, 13-1/2"L x 13"W x 4"H.

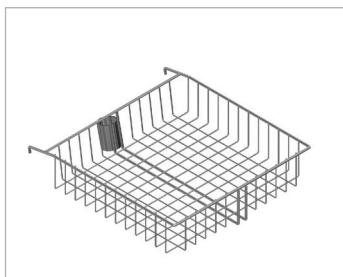

AVAILABLE FINISHES: BLK ● CHR ●

2231

Literature basket 13-1/2"L x 9"W x 4-1/2"H.

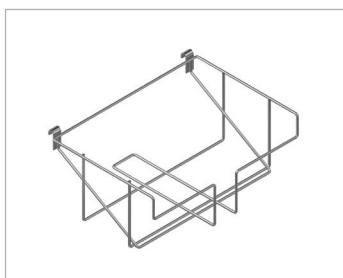

AVAILABLE FINISH: CHR ●



AVAILABLE FINISH: CHR ●

2206

5-1/2"H x 7"W card frame with fittings for 1/4" or 3/8" stem (rounded corners).

2207

7"H x 11"W card frame with fittings for 1/4" or 3/8" stem (rounded corners).

2208

11"H x 14"W card frame with fittings for 1/4" or 3/8" stem (rounded corners).

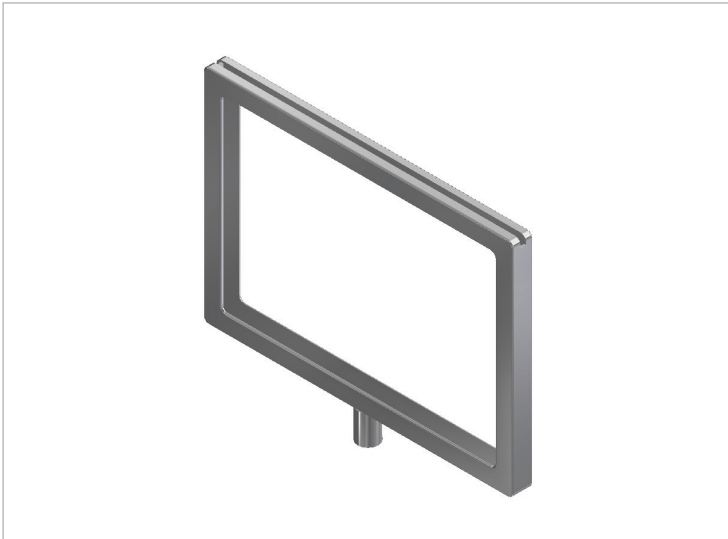

AVAILABLE FINISH: CHR ●

2209

5-1/2"H x 7"W card frame with fittings for 1/4" or 3/8" stem.

2210

7"H x 11"W card frame with fittings for 1/4" or 3/8" stem.

2211

11"H x 14"W card frame with fittings for 1/4" or 3/8" stem.

2236

8-1/2"H x 11"W card frame with fittings for 1/4" or 3/8" stem.

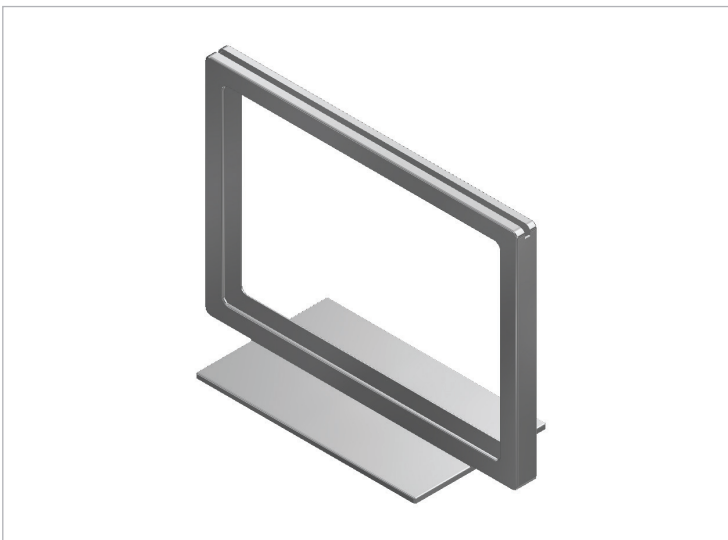

AVAILABLE FINISH: CHR ●

2212

5-1/2"H x 7"W card frame with 3" x 5" felt base.

2213

7"H x 11"W card frame with 3" x 5" felt base.

2214

11"H x 14"W card frame with 4" x 7" felt base.

2215

5-1/2"H x 7"W card frame with bottom magnet.

2216

7"H x 11"W card frame with bottom magnet.

2217

11"H x 14"W card frame with bottom magnet.



AVAILABLE FINISH: CHR 

2224

5-1/2"H x 7"W card frame with 4" stems and 3-1/2" x 5" felt bottom base.

2225

7"H x 11"W card frame with 4" stems and 3-1/2" x 5" felt bottom base.

2226

11"H x 14"W card frame with 4" stems and 4" x 7" felt bottom base.



AVAILABLE FINISH: CHR 

2227

14"H x 11"W card frame with fittings for 1/4" or 3/8" stem.

2237

11"H x 8-1/2"W card frame with fittings for 1/4" or 3/8" stem.

2238

11"H x 7"W card frame with fittings for 1/4" or 3/8" stem.

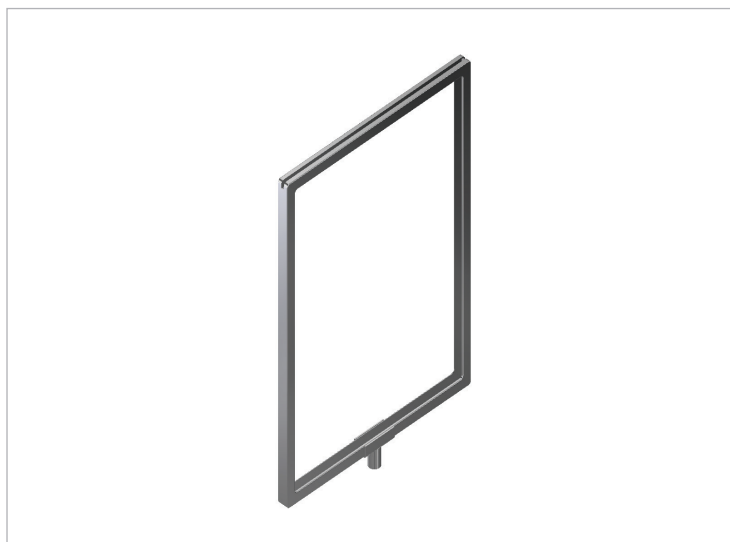

AVAILABLE FINISH: CHR 



AVAILABLE FINISH: CHR ●

2228

5-1/2"H x 7"W wall mount card frame.

2229

7"H x 11"W wall mount card frame.

2230

11"H x 14"W wall mount card frame.

2232

5-1/2"H x 7"W wall mount card frame.



AVAILABLE FINISH: CHR ●

2218

5-1/2"H x 7"W card frame with 10" non-adjustable stem and shovel base.

2219

7"H x 11"W card frame with 10" non-adjustable stem and shovel base.

2220

11"H x 14"W card frame with 10" non-adjustable stem and shovel base.

2221

5-1/2"H x 7"W card frame with stem adjustable from 14" to 22" high, shovel base.

2222

7"H x 11"W card frame with stem adjustable from 14" to 22" high, shovel base.

2223

11"H x 14"W card frame with stem adjustable from 14" to 22" high, shovel base.

2241C

11"H x 7"W card frame with 10" non-adjustable stem and shovel base.

2300-3

3" stem with 3/8" - 27 threaded ends.

2300-4

4" stem with 3/8" - 27 threaded ends.

2300-12

12" stem with 3/8" - 27 threaded ends.

2300-14

14" stem with 3/8" - 27 threaded ends.

2300-18

18" stem with 3/8" - 27 threaded ends.

2301-6

6" stem with 3/8" - 27 threaded ends.

2302-10

10" stem with 3/8" - 27 threaded ends.

AVAILABLE FINISH: CHR 



2303

3" swaged stem, 3/8" - 27.

2304

6" swaged stem, 3/8" - 27.



AVAILABLE FINISH: CHR 

2305

Swaged cup fitting holds 3/8" swaged stem (cup fits into 9/16" hole).

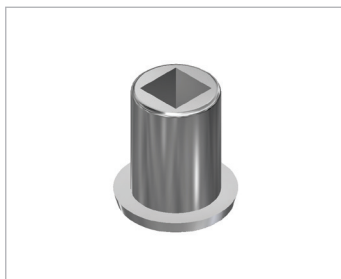

AVAILABLE FINISH: CHR 



2306

Threaded magnetic holder for 3/8" stems.

2307

Swaged magnetic holder for 3/8" stems.

AVAILABLE FINISH: CHR 

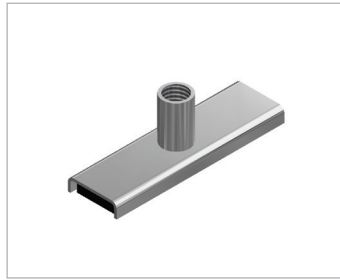

2308

3" long magnetic holder with 1/4" and 3/8" fitting.

AVAILABLE FINISH: CHR 

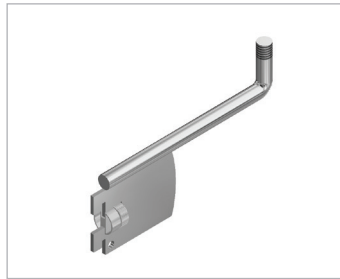

2309

Card frame attachment for 1/2" slot, 1" OC wall standards. 5" long with 3/8" threading.

2310

Card frame attachment for 1/2" slot, 1" OC wall standards. 12" long with 3/8" threading.

AVAILABLE FINISH: CHR 



2311

All-purpose clamp for round, square and rectangular tube with 1/4" and 3/8" fitting.

AVAILABLE FINISH: CHR 



2312

"C" clamp with 2" stem for 3/8" threading (fits 1" and 1-1/16" diameter round tube).

2313

"C" clamp with 2" stem for 3/8" threading (fits 1-1/4" and 1-5/16" diameter round tube).

AVAILABLE FINISH: CHR 

2314

"O" clamp with 2" stem for 3/8" threading
(fits 1" and 1-1/16" diameter round tube).



AVAILABLE FINISH: CHR 

2315

"O" clamp with 2" stem for 3/8" threading
(fits 1-1/4" and 1-5/16" diameter round tube).

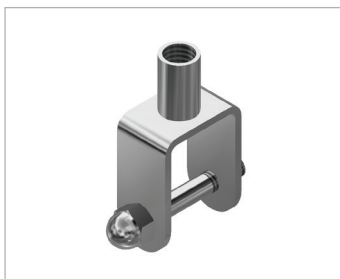

AVAILABLE FINISH: CHR 

2318

Square tubing clamp with no stem (fits 1" square tubing with 3/8" fitting).

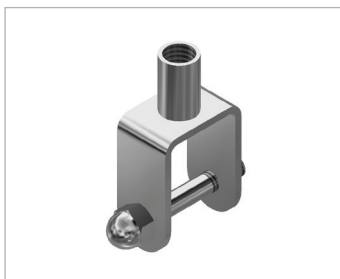

AVAILABLE FINISH: CHR 

2319

Square tubing clamp with 3" stem for 3/4" to 7/8" square tube.



AVAILABLE FINISH: CHR 

2320

Rectangular tubing clamp with 2" stem and 3/8" fitting (fits 1/2" x 1-1/2" rectangular tube).

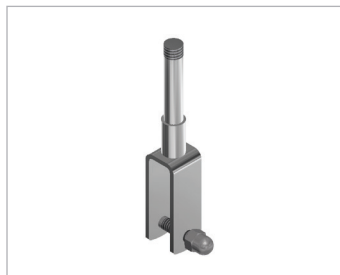

AVAILABLE FINISH: CHR 

2321

Rectangular tubing clamp with no stem and 3/8" fitting (fits 1/2" x 1-1/2" rectangular tube).

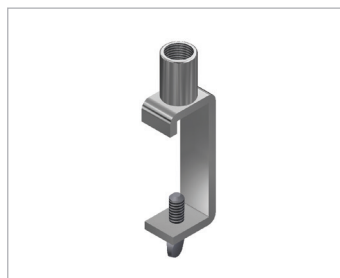

AVAILABLE FINISH: CHR 



2322

Spring clamp fits 1" square tube with 1/4" and 3/8" fitting.

AVAILABLE FINISH: CHR 



2323

Spring clamp fits 1/2" x 1-1/2" rectangular tube with 1/4" and 3/8" fitting.

AVAILABLE FINISH: CHR 

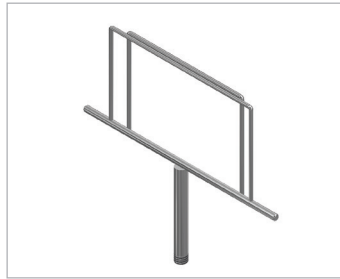

2324

Spring clamp fit 1" x 3/16" flat bar with 1/4" and 3/8" fitting.

2325

Sign holder made of 1/8" wire with 3" stem, 3/8" - 27 threaded.

AVAILABLE FINISH: CHR 

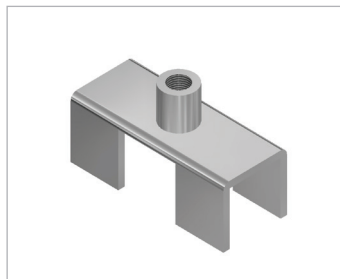

2326

Sign adapter for 1" square tube with 1/4" and 3/8" fitting.

AVAILABLE FINISH: CHR 

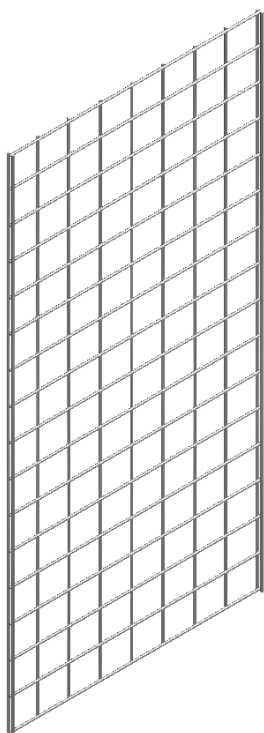

Grid panel 3" x 3" spacing with 1/4" wire, double wire on vertical sides.

AVAILABLE FINISHES: BLK ● CHR ● WHT ○

Item #	W	H
2400-24	2	4
2401-25	2	5
2402-26	2	6
2403-27	2	7
2404-28	2	8
2405-44	4	4
2406-45	4	5
2421-36	3	6

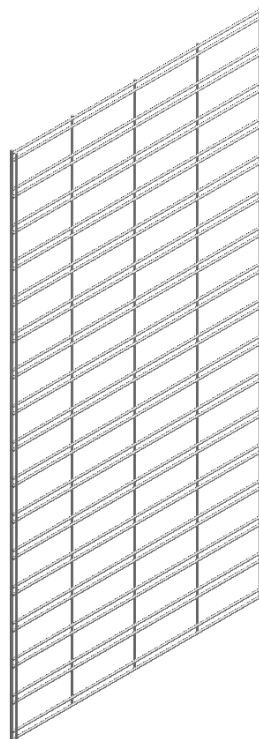

Slatgrid panel 3" x 6" spacing with 1/4" wire, double wire on vertical sides.

AVAILABLE FINISHES: BLK ● CHR ● WHT ○

Item #	W	H
2407-24	2	4
2408-25	2	5
2409-26	2	6
2410-27	2	7
2411-28	2	8
2412-44	4	4
2413-45	4	5

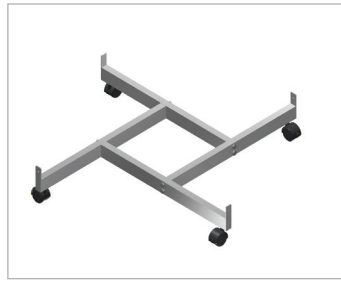

2500

Four way base with twin hooded casters.

AVAILABLE FINISHES: BLK ● CHR ● WHT ○



2501

Triangle base with twin hooded casters.

AVAILABLE FINISHES: BLK ● CHR ● WHT ○

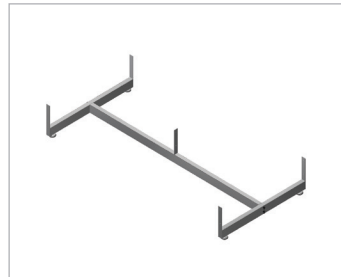

2502

Gondola base with levelers.

AVAILABLE FINISHES: BLK ● CHR ● WHT ○

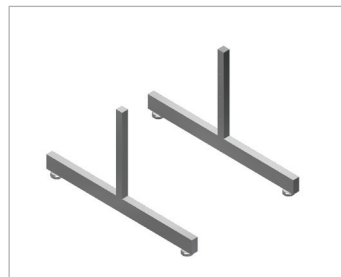

2503

Grid panel leg with 12" upright of 1" square tubing. 24" base of 1" x 2" rectangular tube, levelers included.

AVAILABLE FINISHES: BLK ● CHR ● WHT ○

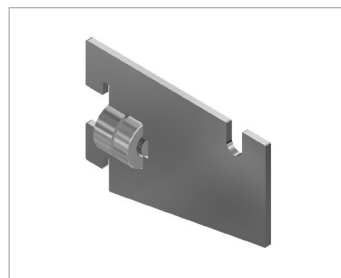

2504

Grid panel support bracket for 1/2" slot, 1" OC wall standards.

AVAILABLE FINISH: CHR ●

2505

Wall mount support bracket for grid, 3" long.

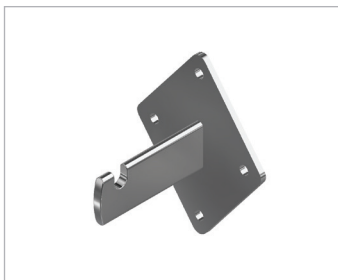

AVAILABLE FINISHES: BLK ● CHR ● WHT ○

2506-6

1/8" diameter ceiling hook. Available sizes: 6", 12", 18", 24", 30", 36", 48", 60" and 72".



AVAILABLE FINISH: CHR ●

2507

Grid panel leg with 60" upright of 1" square tube. 24" base of 1" x 2" rectangular tubing, levelers included.

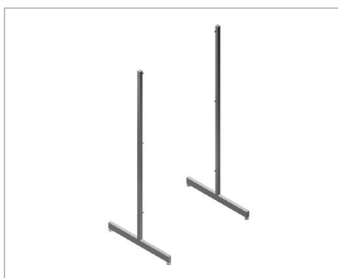

AVAILABLE FINISHES: BLK ● CHR ● WHT ○

2515

Offset grid support bracket for 1/2" slot, 1" OC wall standards (sold in pairs).

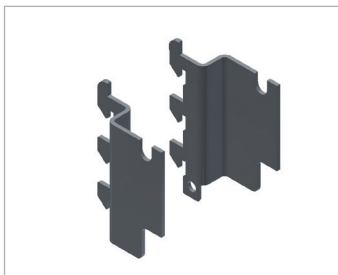

AVAILABLE FINISH: ZNC ●

2516

"L" leg for grid panel, 14"D x 20"H.



AVAILABLE FINISHES: BLK ● CHR ● WHT ○

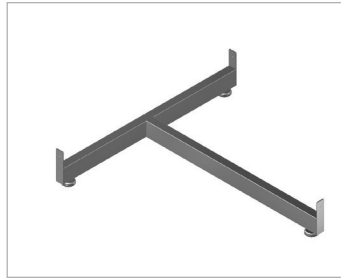

AVAILABLE FINISHES: BLK ● CHR ● WHT ○

2517

"T" base for grid panel, levelers included.

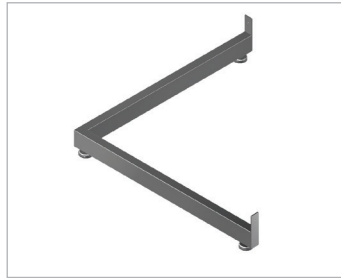

AVAILABLE FINISHES: BLK ● CHR ● WHT ○

2518

"L" base for grid panel, levelers included.



AVAILABLE FINISHES: BLK ● CHR ● WHT ○

2522

Grid wall mount bracket, 14GA metal plate.



AVAILABLE FINISHES: BLK ● CHR ● WHT ○

2523

Grid sign clip.



AVAILABLE FINISH: WHT ○

OUC-003

Grid panel leg.

2508

Heavy duty grid connector.

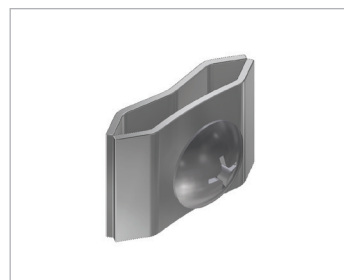

AVAILABLE FINISHES: BLK ● CHR ● WHT ○

2509

General duty grid connector.

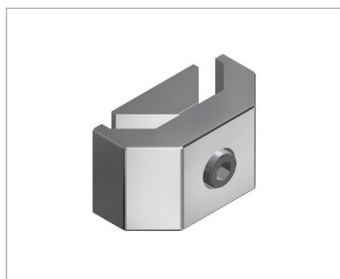

AVAILABLE FINISH: CHR ●

2510

Two-way grid connector. Connects two panels at 90-degree angle.

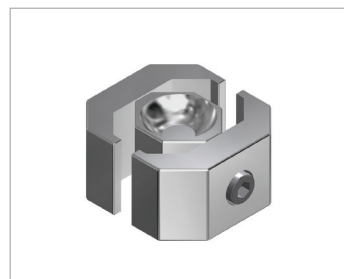
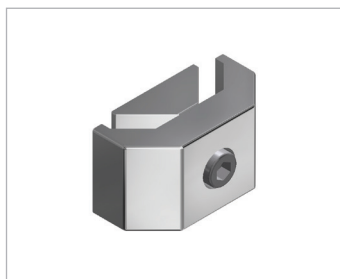

2511

Four-way grid connector. Connects four panels at 90-degree angle.

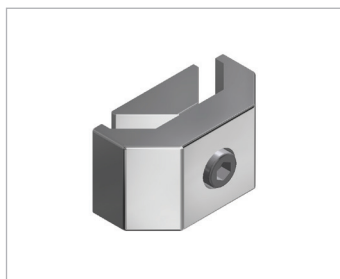

AVAILABLE FINISH: CHR ●

2512

Grid to square tubing connector for double wired edge. Connects 1" square tubing to grid panel.



AVAILABLE FINISHES: BLK ● CHR ● WHT ○

2513

Grid to square tubing connector for single wired edge. Connects 1" square tubing to grid panel.



AVAILABLE FINISHES: BLK ● CHR ● WHT ○

2514

Square tubing connector. Connects 1" square tubing to 1" square tubing at 90, 135 or 180 degree angles.



AVAILABLE FINISH: CHR ●

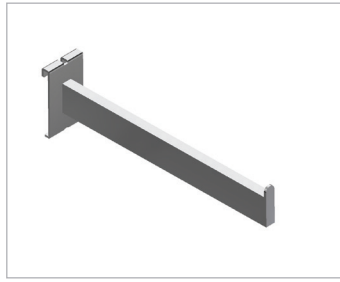

2600

12" faceout of 1/2" x 1-1/2" rectangular tubing.

AVAILABLE FINISH: CHR ●

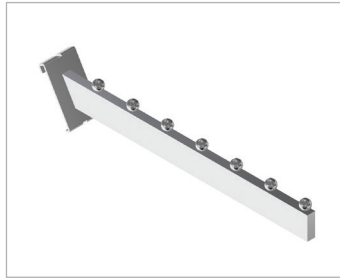

2601

16" waterfall with 7 balls in 1/2" x 1-1/2" rectangular tubing.

AVAILABLE FINISHES: CHR ● WHT ○

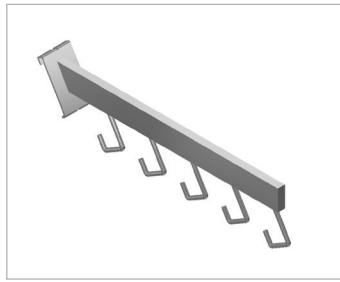
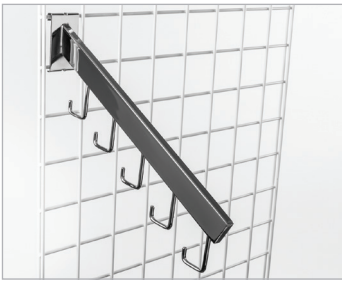

2602

16" waterfall with 5 hooks in 1/2" x 1-1/2" rectangular tubing.

AVAILABLE FINISH: CHR ●



2603

12" hangrail bracket for 1" & 1-1/16" round tubing.

2604

12" hangrail bracket for 1-1/4" & 1-5/16" round tubing.

AVAILABLE FINISH: CHR ●

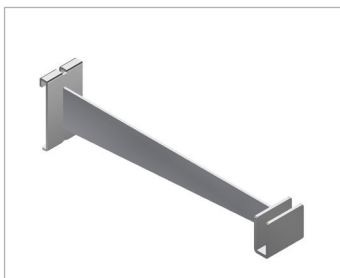

2605

12" hangrail bracket for 1/2" x 1-1/2" rectangular tubing.

AVAILABLE FINISH: CHR ●

2606

Shelf bracket. Available sizes: 8", 10", 12" and 14".

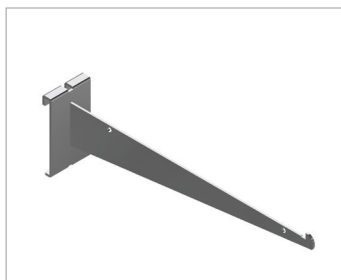

AVAILABLE FINISHES: BLK ● CHR ● WHT ○

2607-6

6" faceout of 3/4" square tubing.

2607

12" faceout of 3/4" square tubing.

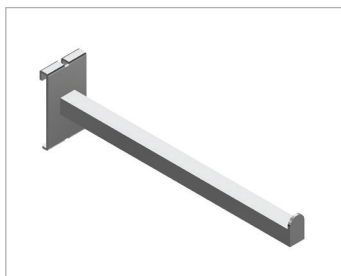

AVAILABLE FINISHES: BLK ● CHR ● WHT ○

2608-7

7" waterfall with 3 balls in 3/4" square tubing.

2608

16" waterfall with 6 balls in 3/4" square tubing.

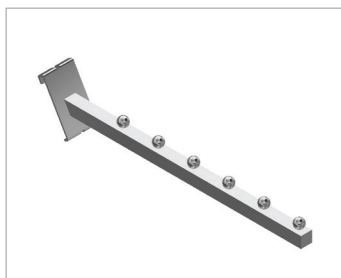

AVAILABLE FINISHES: BLK ● CHR ● WHT ○

2609

16" waterfall with 5 hooks in 3/4" square tubing.

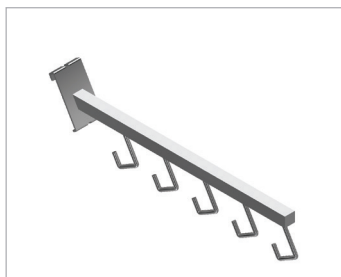

AVAILABLE FINISHES: BLK ● CHR ● WHT ○

2610

1/4" wire hook with notched top plate.
Available sizes: 1", 4", 6", 8", 10", and 12".

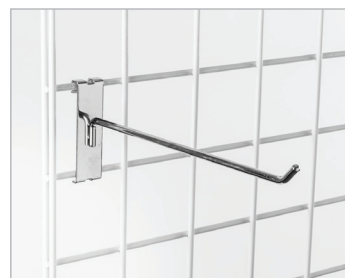
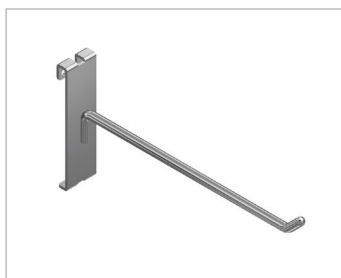

AVAILABLE FINISHES: BLK ● CHR ● WHT ○

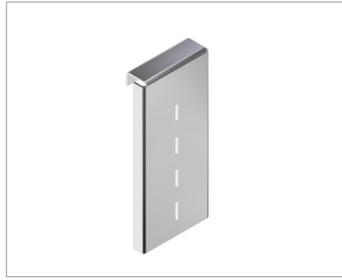

2612

Slotted adapter. Attaches 1/2" slot, 1" OC wall standard accessories to grid.

AVAILABLE FINISH: CHR ●

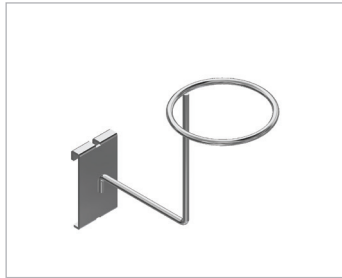

2614

Hat display for grid with 4" ring, 6" high and 4-1/2" deep.

AVAILABLE FINISH: CHR ●

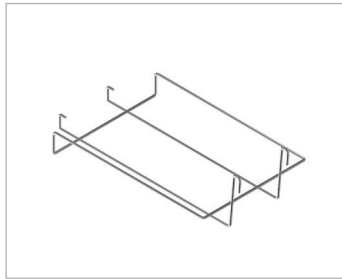
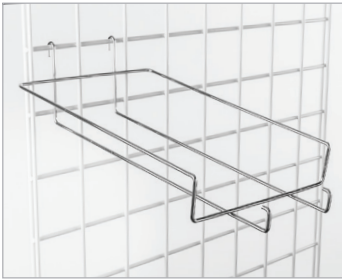

2615

Cap merchandiser for grid, holds six caps.

AVAILABLE FINISHES: BLK ● CHR ● WHT ○

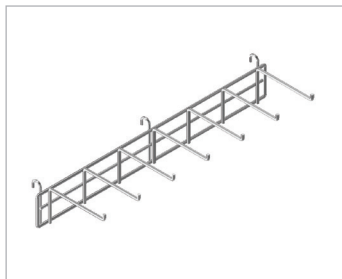

2619

Belt / tie holder for grid, 24" long with seven 5-1/2" hooks.

AVAILABLE FINISH: CHR ●

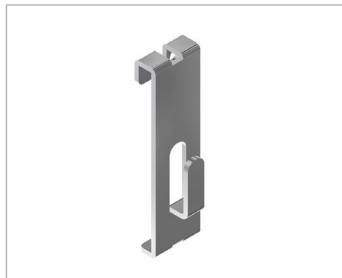

2620

Frame hook for grid panel.

AVAILABLE FINISHES: BLK ● CHR ● WHT ○

2621

Display hook for grid panel.

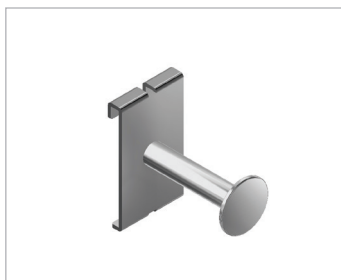

AVAILABLE FINISHES: BLK ● CHR ● WHT ○

2623B

4-1/2"L x 2-1/2"W x 7"H literature holder.

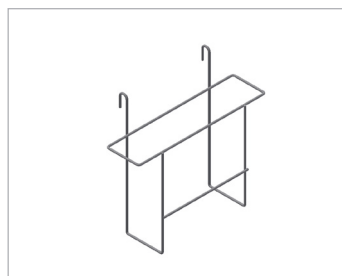
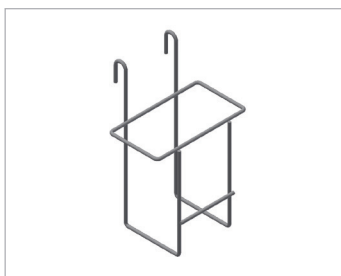

AVAILABLE FINISH: BLK ●

2624B

9-1/2"L x 2-1/2"W x 9" H literature holder.

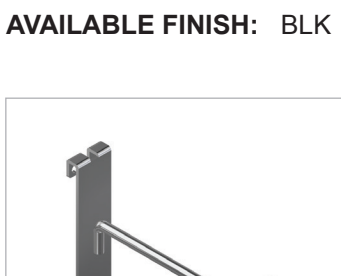

2625

1/4" wire safety hook for grid. Available sizes: 4", 6", 8", 10" and 12".



AVAILABLE FINISHES: BLK ● CHR ● WHT ○

2626

3/16" wire loop hook for grid. Available sizes: 4", 6", 9" and 12".



AVAILABLE FINISHES: BLK ● CHR ● WHT ○

OUC-002

1" round hangrail adapter.

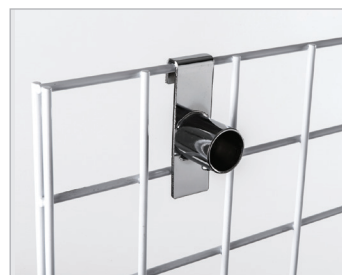

AVAILABLE FINISH: CHR ●

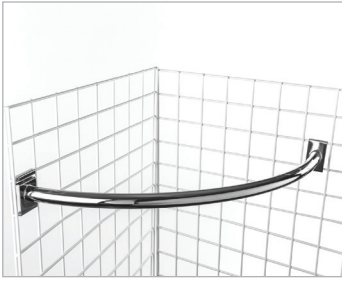

AVAILABLE FINISH: CHR ●

2700

Quarter hangrail of 1-1/4" diameter round tubing.

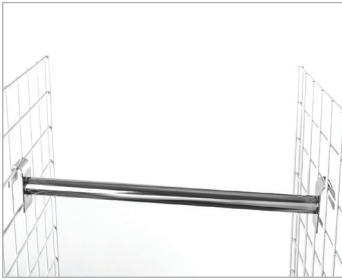

AVAILABLE FINISH: CHR ●

2701-24

24-1/4" long straight hangrail for grid, 1-1/4" diameter round tubing.

2701-48

48-1/4" long straight hangrail for grid, 1-1/4" diameter round tubing.

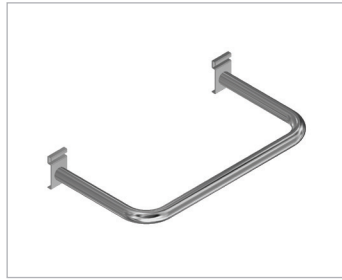

AVAILABLE FINISHES: BLK ● CHR ● WHT ○

2702

52-1/4" long straight hangrail for grid, 1-1/4" diameter round tubing.

2703

"U" bar of 1-1/4 diameter round tubing, 12" x 23" .

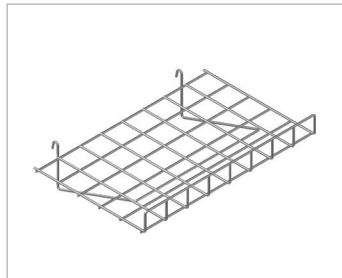
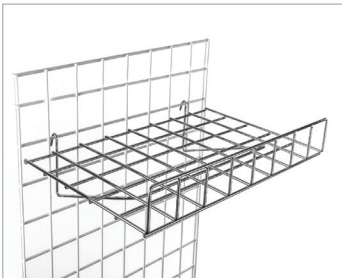

AVAILABLE FINISHES: BLK ● CHR ● WHT ○

2704

Straight grid shelf of 1/4" wire, 24"L x 15"W with 3" front lip.

2705

Slant grid shelf of 1/4" wire, 24"L x 15"W with 3" front lip.



AVAILABLE FINISHES: BLK ● CHR ● WHT ○

2706

Corner grid shelf of 1/4" wire, 23" x 34" x 23".

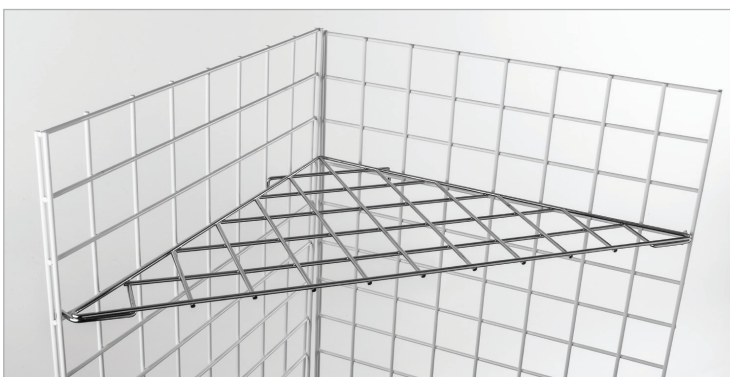

AVAILABLE FINISHES: BLK ● CHR ● WHT ○

2707

Flat grid shelf 20"L x 14"W.

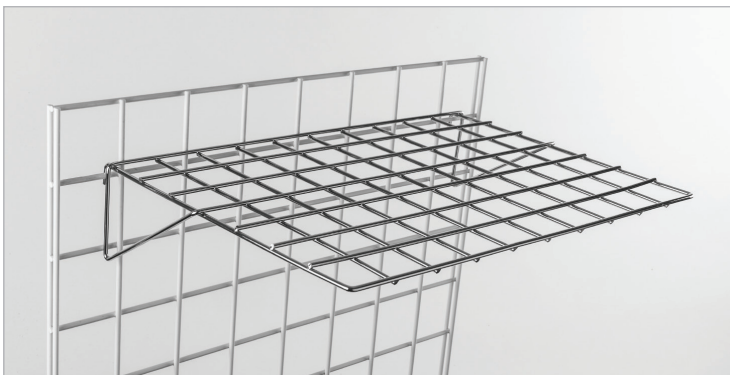

AVAILABLE FINISHES: BLK ● CHR ● WHT ○

2708

Large basket for grid, 24"L x 12"W x 6"H.



AVAILABLE FINISHES: BLK ● CHR ● WHT ○

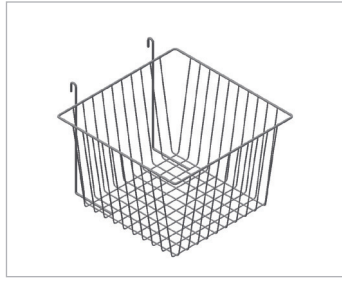

AVAILABLE FINISHES: BLK ● WHT ○

2709

Small basket for grid, 12"L x 12"W x 8"H.

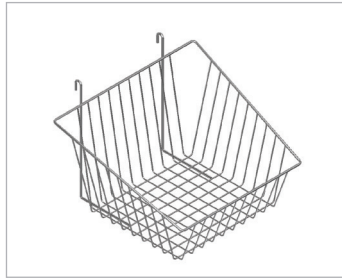

AVAILABLE FINISHES: BLK ● WHT ○

2710

Slant front basket for grid, 12"L x 12"W x 8"H.

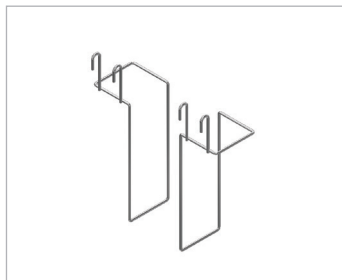

AVAILABLE FINISH: CHR ●

2712

Adjustable literature holder for grid, 6" high (sold in pairs).

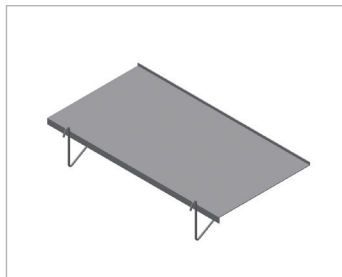
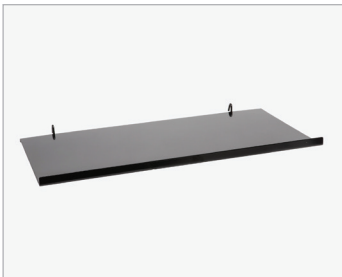

AVAILABLE FINISHES: BLK ● WHT ○

2730

Straight 24"L x 12"W sheet metal shelf with 5/8" front lip.

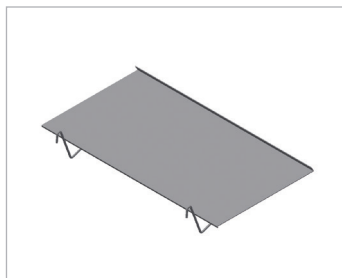

AAAVAILABLE FINISHES: BLK ● WHT ○

2731

Slant 24"L x 12"W sheet metal shelf with 5/8" front lip.

2732

6" x 6" video shelf for grid panel. Available sizes: 24" and 48".



AVAILABLE FINISHES: BLK ● WHT ○

2733

12"L x 12"W x 4"H small wire basket.



AVAILABLE FINISHES: BLK ● WHT ○

2734

24"L x 13"W x 4"H wire basket for grid.



AVAILABLE FINISH: WHT ○

2735

24"L x 12"W x 4"H wire basket for grid.

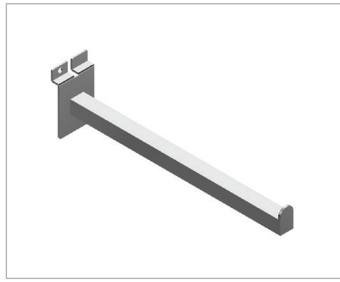
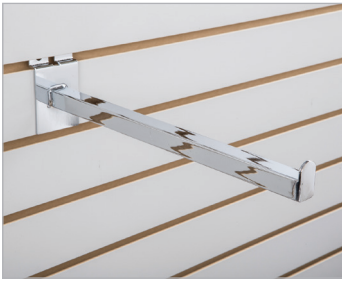

AVAILABLE FINISHES: BLK ● WHT ○

**2800**

12" slatwall faceout, 3/4" square tubing.

2801

16" slatwall faceout, 3/4" square tubing (chrome only).

AVAILABLE FINISHES: BLK ● CHR ● WHT ○

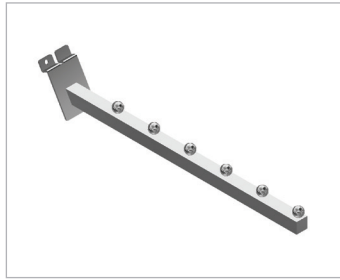
**2802**

16" slatwall waterfall with 6 balls, 3/4" square tubing.

AVAILABLE FINISHES: BLK ● CHR ● WHT ○

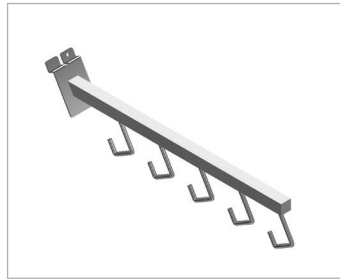
**2803**

16" waterfall with 5 hooks, 3/4" square tubing for slatwall.

AVAILABLE FINISHES: BLK ● CHR ● WHT ○

**2804**

12" hangrail bracket for 1" & 1-1/16" round tubing.

2805

12" hangrail bracket for 1-1/4" & 1-5/16" round tubing.

AVAILABLE FINISH: CHR ●

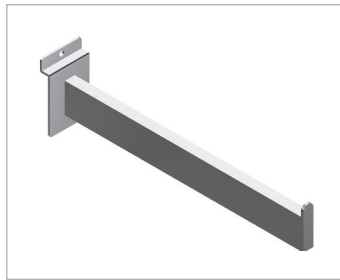
**2806**

12" slatwall faceout, 1/2" x 1-1/2" rectangular tubing.

2806-6

6" slatwall faceout, 1/2" x 1-1/2" rectangular tubing.

AVAILABLE FINISHES: BLK ● CHR ● WHT ○

2807

16" waterfall with 7 balls, 1/2" x 1-1/2" rectangular tubing.

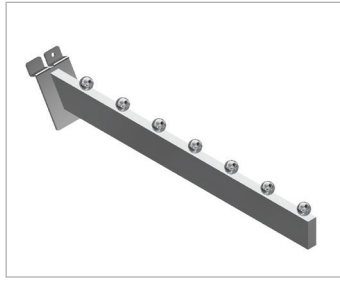

AVAILABLE FINISHES: BLK ● CHR ● WHT ○

2807-7

7" waterfall with 3 balls, 1/2" x 1-1/2" rectangular tubing.

2808

16" waterfall with 5 hooks, 1/2" x 1-1/2" rectangular tubing.

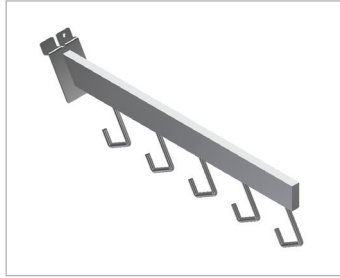

AVAILABLE FINISH: CHR ●

2809

16" faceout with 5 hooks, 1/2" x 1-1/2" rectangular tubing.

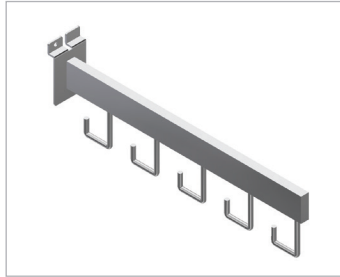

AVAILABLE FINISH: CHR ●

2810

Slatwall shelf brackets. Available sizes: 6", 8", 10", 12", 14" and 16" (16" available in chrome finish only).



AVAILABLE FINISHES: BLK ● CHR ● WHT ○

2811

Adjustable shelf bracket with 5 position screw lock. Available sizes: 8", 10", 12" and 14".

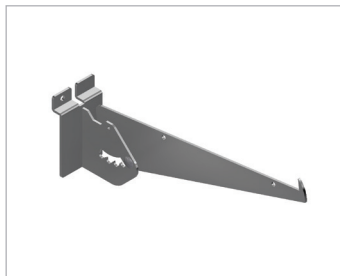

AVAILABLE FINISH: CHR ●

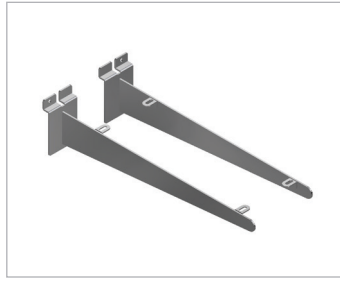
**2812**

Slatwall wood shelf bracket. Available sizes: 8", 10", 12" and 14" (sold in pairs).

AVAILABLE FINISH: CHR 

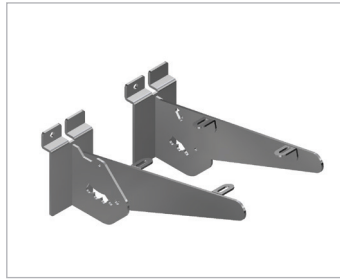
**2813**

Adjustable wood shelf brackets with 5 position screw lock. Available sizes: 8", 10", 12" and 14" (sold in pairs).

AVAILABLE FINISH: CHR 

**2814**

1/4" wire hooks. Available sizes: 1", 4", 6", 8", 10" and 12".

AVAILABLE FINISHES: BLK  CHR  WHT  RAW 

**2816**

Slatwall frame hook.

AVAILABLE FINISHES: BLK  CHR  WHT 

**2817**

1/4" wire safety hooks. Available sizes: 4", 6", 8", 9", 10" and 12" (9" available in chrome and satin chrome only).

AVAILABLE FINISHES: BLK  CHR  WHT  SAT 

2818

7" waterfall with 3 balls, 3/4" square tubing.

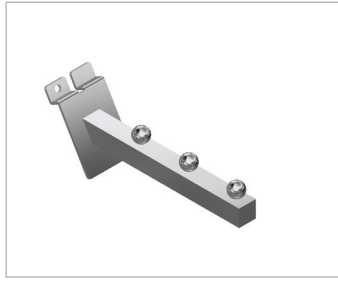

AVAILABLE FINISH: CHR ☒

2819

Lightweight 3/16" wire hooks. Available sizes: 4", 6", 8", 10" and 12".

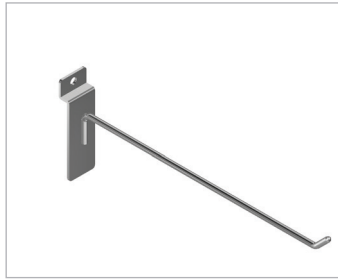

AVAILABLE FINISH: CHR ☒

2820

3/16" wire loop hooks. Available sizes: 4", 6" and 8".



AVAILABLE FINISHES: BLK ☒ WHT ☐

2822

Slatwall wood panel adapter.

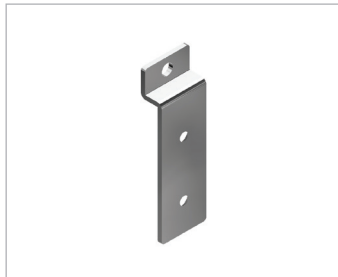

AVAILABLE FINISH: ZNC ☒

ROY-001

Eyeglasses display hook for slatwall.

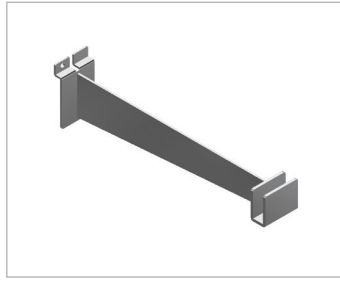
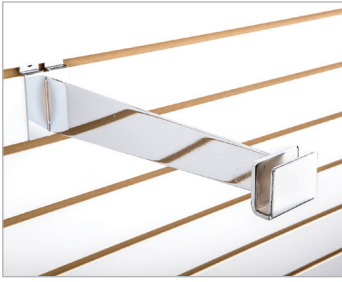

AVAILABLE FINISH: CHR ☒

**2900**

12" hangrail bracket for 1/2" x 1-1/2" rectangular tubing.

AVAILABLE FINISH: CHR ●

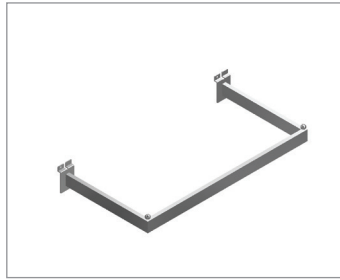
**2901**

"U" hang tube of 1/2" x 1-1/2" rectangular tubing. Available sizes: 24", 36" and 48".

AVAILABLE FINISH: CHR ●

**2902**

Glass shelf support for "U" hang tubing.

AVAILABLE FINISH: CHR ●

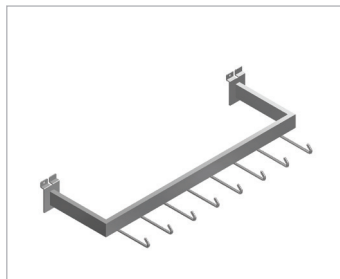
**2903**

Belt / tie bar. 7"W x 24"L with eight 4" prongs.

AVAILABLE FINISH: CHR ●

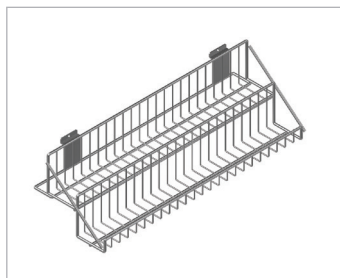
**2904**

Book shelf with two pockets. Each pocket is 3" deep. Available sizes: 24" and 48".

AVAILABLE FINISHES: BLK ● WHT ○

2906

Wire basket, 12"W x 24"L x 6"H.

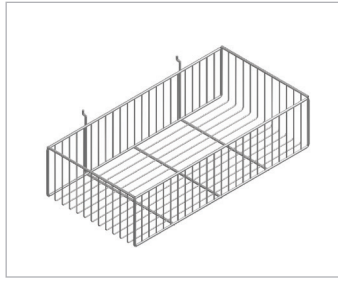

AVAILABLE FINISHES: BLK ● CHR ● WHT ○

2907

Flat wire shelf of 3/16" wire, 13-1/4"W x 20"L.

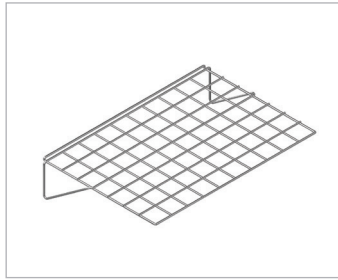

AVAILABLE FINISHES: BLK ● CHR ● WHT ○

2908

Flat wire shelf for slatwall and slatgrid of 3/16" wire, 14"W x 20"L.

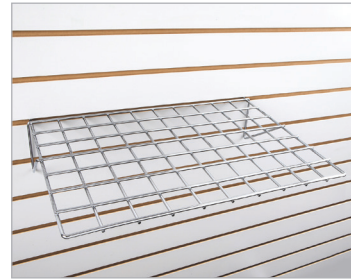
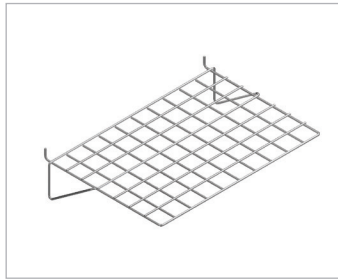

AVAILABLE FINISHES: BLK ● CHR ● WHT ○

2909

Hat display with 4" ring, 6"L x 6"H.

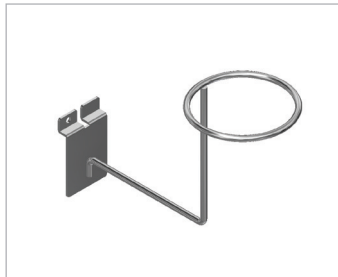

AVAILABLE FINISHES: BLK ● CHR ● WHT ○

2910

Cap merchandiser, holds six caps.

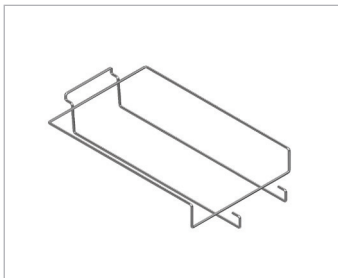

AVAILABLE FINISHES: BLK ● CHR ● WHT ○

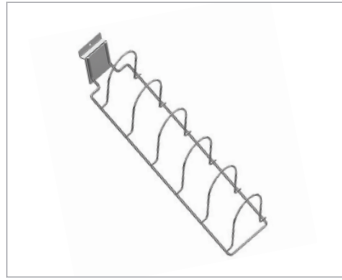
**2911**

Clutch bag display, 5"W x 18"L.

AVAILABLE FINISH: CHR ●

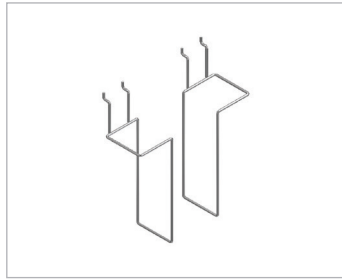
**2912**

Adjustable literature holder, 6" high (sold in pairs).

AVAILABLE FINISH: CHR ●

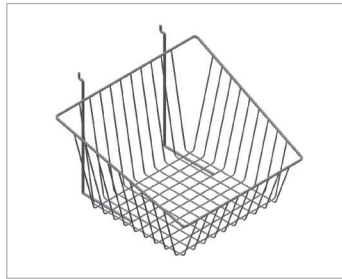
**2919**

Slant front basket, 12"W x 12"L x 8"H.

AVAILABLE FINISHES: BLK ● WHT ○

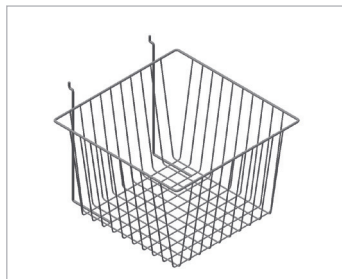
**2920**

Small basket, 12"W x 12"L x 8"H.

AVAILABLE FINISHES: BLK ● WHT ○

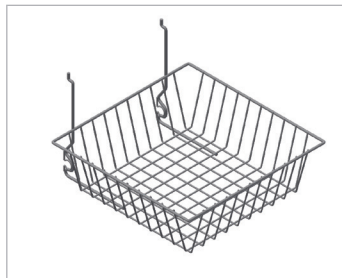
**2921**

Small basket, 12"W x 12"L x 4"H.

AVAILABLE FINISHES: BLK ● WHT ○

2922

Scarecrow displayer, adjustable from 20-1/2" to 34-3/4".

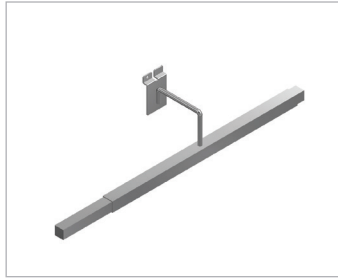

AVAILABLE FINISHES: BLK ● CHR ● WHT ○

2923

4-1/2"L x 2-1/2"W x 7"H literature holder for slatwall.

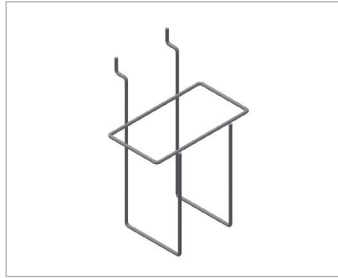

AVAILABLE FINISH: BLK ●

2924

9-1/2"L x 2-1/2"W x 9"H literature holder for slatwall.



AVAILABLE FINISHES: BLK ● WHT ○

2932

Straight 24"L x 12"W metal shelf with 5/8" front lip.

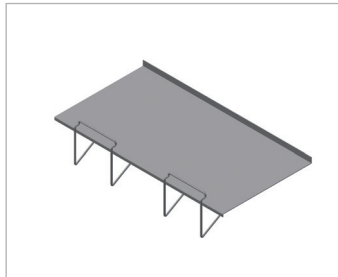

AVAILABLE FINISHES: BLK ● WHT ○

2933

Slant 24"L x 12"W metal shelf with 5/8" front lip.

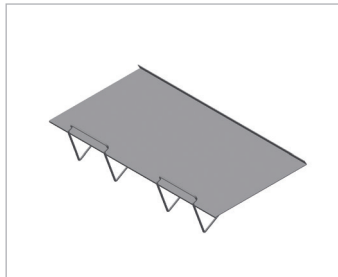

AVAILABLE FINISHES: BLK ● WHT ○

2935-24

6" x 6" video shelf for slatwall, 24" long.

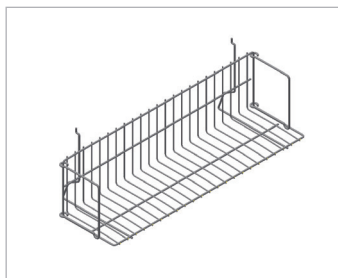

AVAILABLE FINISHES: BLK ● WHT ○

2935-48

6" x 6" video shelf for slatwall, 48" long.

AVAILABLE FINISHES: BLK ● WHT ○

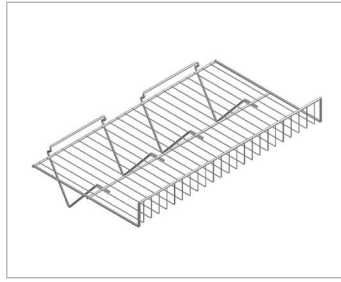
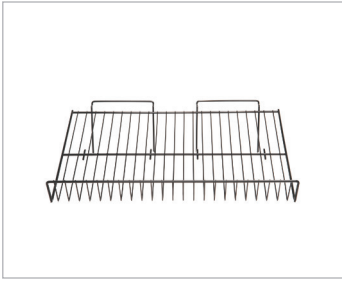
**2936**

Slant shelf of 1/4" wire. 15"W x 24"L with 3" lip.

AVAILABLE FINISHES: BLK ● CHR ● WHT ○

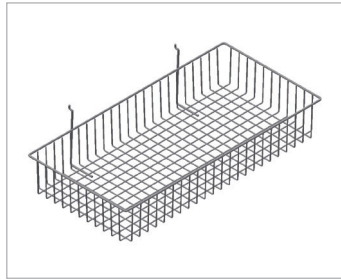
**2937**

24"L x 12"W x 4"H wire basket.

AVAILABLE FINISHES: BLK ● WHT ○

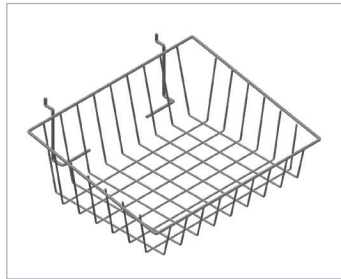
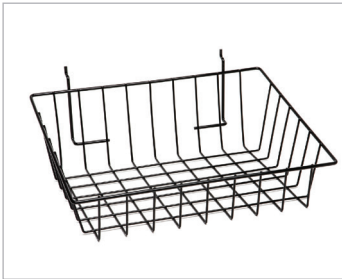
**2938**

12"L x 12"W x 3"H slant front basket.

AVAILABLE FINISHES: BLK ● WHT ○

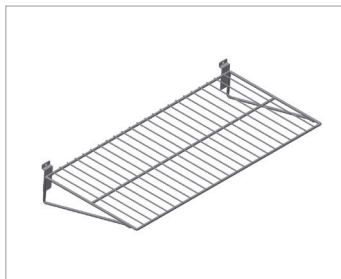
**2939**

24" L X 12"W wire straight shelf.

AVAILABLE FINISHES: BLK ● WHT ○

3100

Two way connector (fits 3/16" glass).



AVAILABLE FINISH: CHR 

3102

Four way connector (fits 3/16" glass).



AVAILABLE FINISH: CHR 

3103

Two way connector, 120 degree (fits 3/16" glass).



AVAILABLE FINISH: CHR 

3104

Three way connector, 120 degree (fits 3/16" glass).

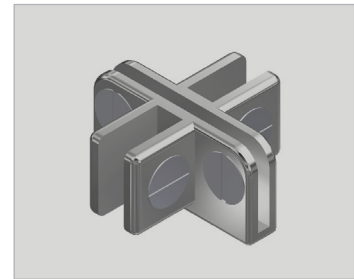

AVAILABLE FINISH: CHR 

3105

Four way cross binning connector (fits 3/16" glass).

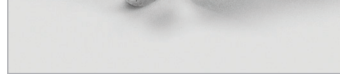

AVAILABLE FINISH: CHR 

3106

Single hinge connector (fits 3/16" glass).



AVAILABLE FINISH: CHR 

3107

End binning connector (fits 3/16" glass).



AVAILABLE FINISH: CHR 

3108

Double hinge connector (fits 3/16" glass).



AVAILABLE FINISH: CHR 



3200

5-1/2"H x 7"W plexi card holder with chrome channel mounted on two 4" stems with 3-1/2" x 5" felt bottom base.

3201

7"H x 11"W plexi card holder with chrome channel mounted on two 4" stems with 3-1/2" x 5" felt bottom base.



3202

5-1/2"H x 7"W plexi card holder with chrome channel for 1/4" & 3/8" fittings. For use with clamps, stems and T-stands.

3203

7"H x 11"W plexi card holder with chrome channel for 1/4" & 3/8" fittings. For use with clamps, stems and T-stands.

3230

8-1/2"H x 11"W plexi card holder with chrome channel for 1/4" & 3/8" fittings. For use with clamps, stems and T-stands.



3223

11"H x 7"W plexi card holder with chrome channel for 1/4" & 3/8" fittings. For use with clamps, stems and T-stands.

3231

11"H x 8-1/2"W plexi card holder with chrome channel for 1/4" & 3/8" fittings. For use with clamps, stems and T-stands.

3232

14"H x 11"W plexi card holder with chrome channel for 1/4" & 3/8" fittings. For use with clamps, stems and T-stands.

3204

5-1/2"H x 7"W two sided plexi card holder.

3205

7"H x 11"W two sided plexi card holder.

3244

11"W x 8-1/2"H acrylic sign holder, bottom loaded (#3205-811H).

**3206**

Plexi 7" x 5 1/2" two sided card holder.

3207

Plexi 11" x 7" two sided card holder.

3243

8-1/2"W x 11"H acrylic sign holder, bottom loaded (#3205-811V).

**3208**

5-1/2"H x 7"W top loaded plexi card holder.

3209

7"H x 11"W top loaded plexi card holder.

3227

8-1/2"H x 11"W top loaded plexi card holder.





3224

7"H x 5-1/2"W top loaded plexi card holder.

3225

11"H x 7"W top loaded plexi card holder.

3226

11"H x 8-1/2"W top loaded plexi card holder.



3210

7"H x 5-1/2"W slant plexi card holder.

3211

11"H x 7"W slant plexi card holder.

3228

11"H x 8-1/2"W slant plexi card holder.

3212

5-1/2"H x 7"W slatwall plexi card holder.

3213

7"H x 11"W slatwall plexi card holder.

3214

14"H x 11"W slatwall plexi card holder.

**3229**

11"H x 8-1/2"W slatwall plexi card holder.

3242

14"H x 11"W slatwall plexi card holder.

**3215**

5-1/2"H x 7"W grid plexi card holder.

3216

7"H x 11"W grid plexi card holder.





AVAILABLE FINISH: CHR 

3409-U

Inner tubing. 3/8"-27 fitting. Upright, 5/8"-24 fitting (fits 6" & 8" base. 18" adjustable to 36". Base not included).

3410-U

Inner tubing. 3/8"-27 fitting. Upright, 5/8"-24 fitting (fits 6" & 8" base. 24" adjustable to 36". Base not included).

3411-U

Inner tubing. 3/8"-27 fitting. Upright, 5/8"-24 fitting (fits 6" & 8" base. 36" adjustable to 72". Base not included).

3419-U

Inner tubing. 1/4"-20 fitting. Upright, 3/8"-27 fitting (fits 4" & 5" base. 9" adjustable to 18". Base not included).

3420-U

Inner tubing. 1/4"-20 fitting. Upright, 3/8"-27 fitting (fits 4" & 5" base. 12" adjustable to 24". Base not included).

3421-U

Inner tubing. 1/4"-20 fitting. Upright, 3/8"-27 fitting (fits 4" & 5" base. 15" adjustable to 30". Base not included).



AVAILABLE FINISH: CHR 

3423

Round base. 4" base, 3/8"-27.

3424

Round base. 5" base, 3/8"-27.

3425

Round base. 6" base, 5/8"-24.

3426

Round base. 8" base, 5/8"-24.

3700

14" waterfall with 6 balls for 1/4" pegboard and slatwall.

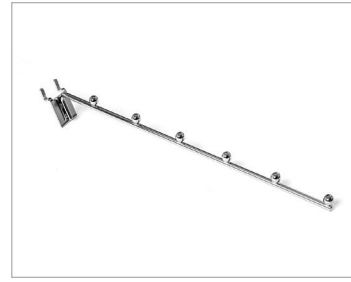
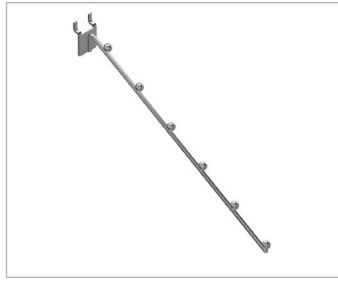

AVAILABLE FINISH: CHR 

3701

16" waterfall with 5 hooks for 1/4" pegboard and slatwall.

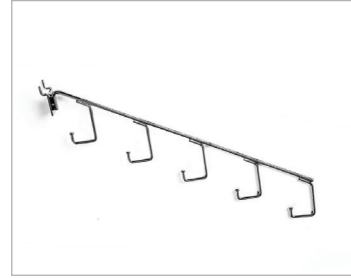
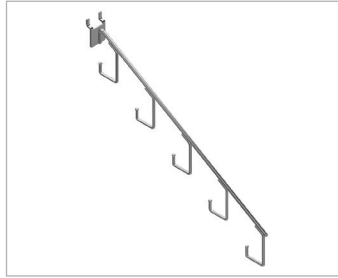

AVAILABLE FINISH: CHR 

3702

Hat / ball display with 4" ring. 6" high, 6" deep. For 1/4" pegboard and slatwall.

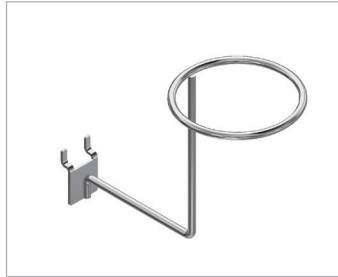

AVAILABLE FINISH: CHR 

3703

Racquet holder. Holds 6 racquets. For 1/4" pegboard and slatwall.

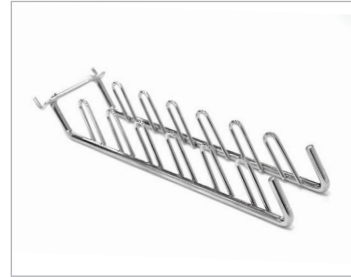

AVAILABLE FINISH: CHR 

3704

Bat holder. Holds 10 bats. For 1/4" pegboard and slatwall.

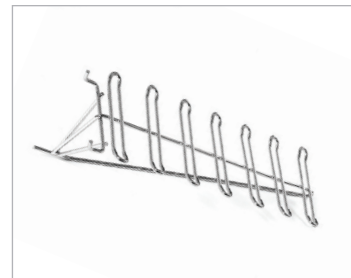
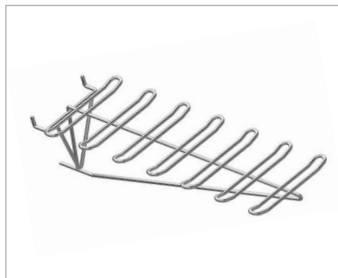

AVAILABLE FINISH: CHR 



AVAILABLE FINISH: CHR 

3800

Stacking basket, 18"W x 23"L x 10"H.

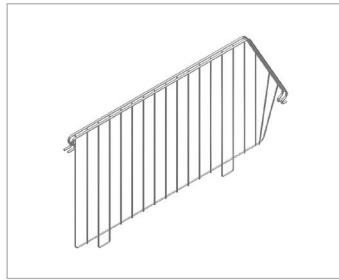
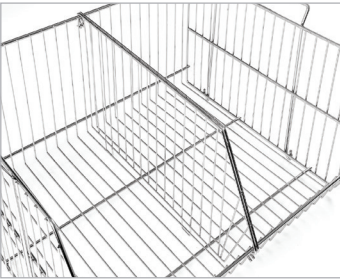

AVAILABLE FINISH: CHR 

3801

Divider for stacking basket.



AVAILABLE FINISH: CHR 

3802

Stacking basket unit. Four baskets high. Each basket is 18"W x 23"L x 10"H. Includes casters.

3803

Mobile merchandiser. 18"W x 23"L x 58"H.
Dividers included. Includes four casters,
two with lock and two without lock.



AVAILABLE FINISHES: BLK ● CHR ● WHT ○

3805

Rolling dump bin. 48"W x 48"L x 30"H.
Includes four 3" industrial locking wheels.



AVAILABLE FINISH: CHR ●

3806

18"W x 18"L x 33"H folding dump bin.

3807

24"W x 24"L x 33"H folding dump bin.

3809

12"W x 12"L x 33"H folding dump bin.



AVAILABLE FINISHES: BLK ● CHR ● WHT ○

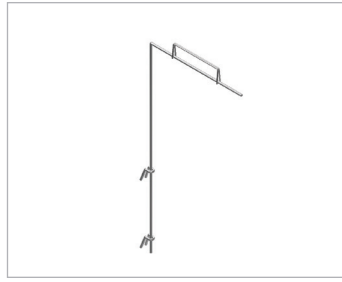
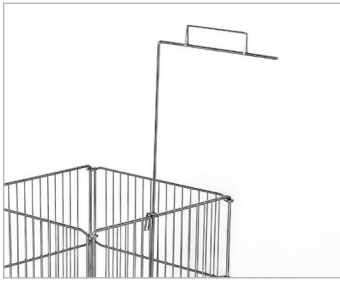

3807-SIGN

24"H sign holder for dump bin.

AVAILABLE FINISHES: BLK ● CHR ● WHT ○



3808

Square dump table. Levelers included.
Available in 36" x 36" and 48" x 48".

AVAILABLE FINISHES: BLK ● CHR ● WHT ○



3813

12" x 18" wire stacking basket and add-on kit
for dump bin. 20" high (fits #3806 & #3812
only).

AVAILABLE FINISH: CHR ●



Heavy duty metal wire shelf.

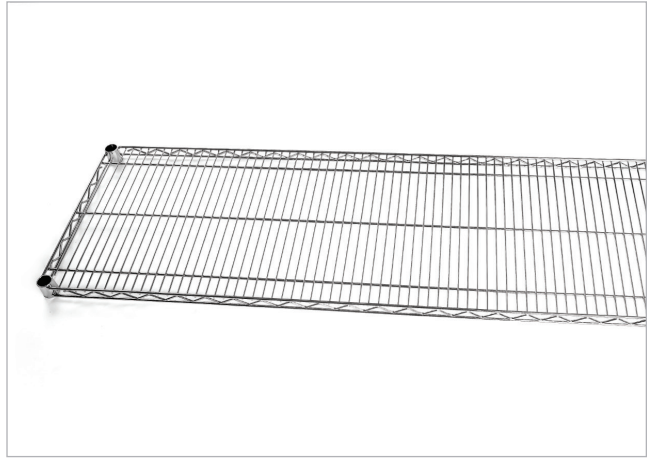

Heavy duty metal wire shelf.

AVAILABLE FINISHES: BLK ● CHR ● WHT ○

Item #	W	L
3900-1836	18	36
3900-1848	18	48
3900-1860	18	60
3900-1872	18	72

Item #	W	L
3902-2424	24	24
3902-2436	24	36
3902-2448	24	48
3917-1436	14	36
3917-1448	14	48
3917-1460	14	60
3917-1472	14	72

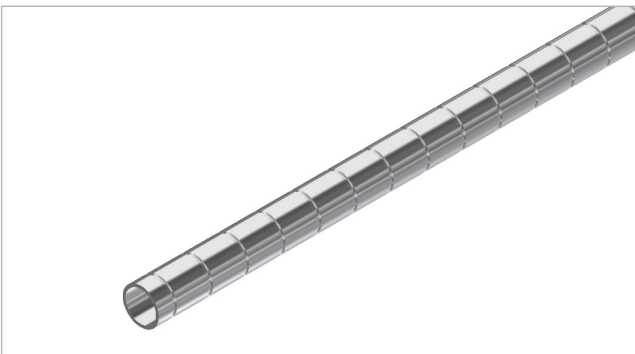

3905

Wire shelf post. Includes inserts for stem casters or levelers. Available sizes: 34", 54", 62", 74" and 86" (86" available in chrome only).

AVAILABLE FINISHES: BLK ● CHR ● WHT ○



3908

Black plastic split fitting for wire shelves.

AVAILABLE FINISH: BLK ●



3909

Black rubber end cap for wire shelf posts.

AVAILABLE FINISH: BLK ●

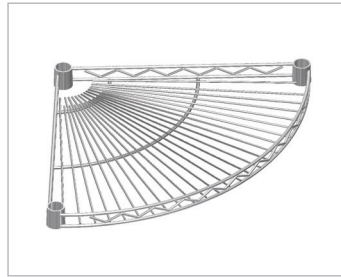

3912

18" quarter round shelf.

AVAILABLE FINISH: CHR ●

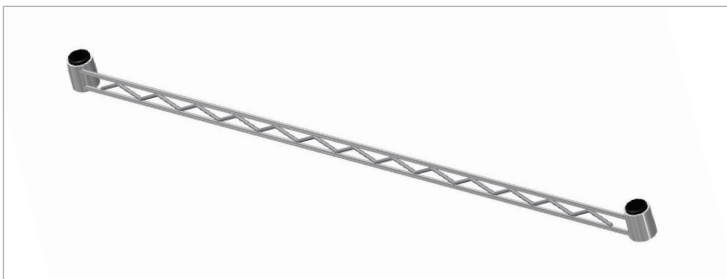

3913

36" or 48" chrome hangrail.

AVAILABLE FINISH: CHR ●



3914

Adjustable leveler.

AVAILABLE FINISH: BLK ●

3915

4" swivel caster with lock.



AVAILABLE FINISH: CHR

3916

4" swivel caster without lock.

3932-36

36" x 4" wire shelf ledge.

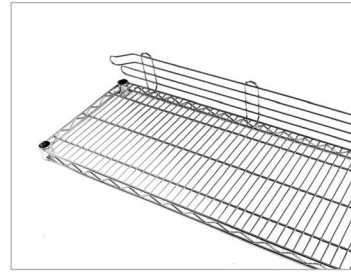
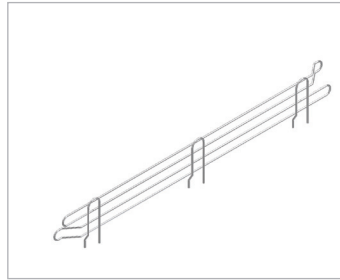

AVAILABLE FINISHES: BLK CHR

3932-48

48" x 4" wire shelf ledge.

3933

Joint / connector for wire shelving post.



AVAILABLE FINISHES: BLK CHR WHT

3934

Sheet metal s-clip for wire shelving unit.



AVAILABLE FINISH: ZNC

3935

Acrylic inlay for wire shelf, clear.

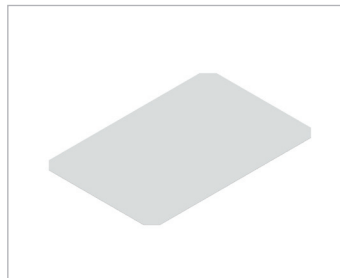

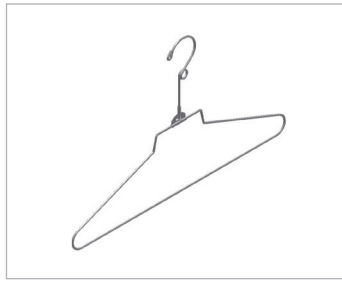
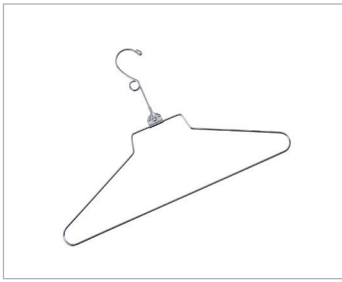

4002

16" dress / blouse hanger with loop hook.

AVAILABLE FINISH: CHR ●

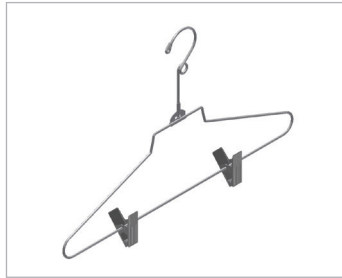
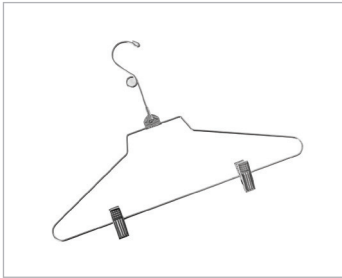

4003

16" suit hanger with loop hook.

AVAILABLE FINISH: CHR ●



4004

12" skirt hanger with swivel hook.

AVAILABLE FINISH: CHR ●

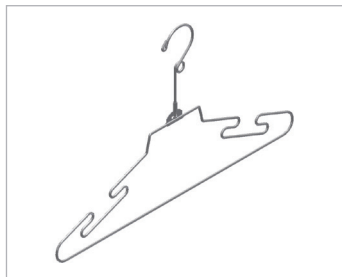
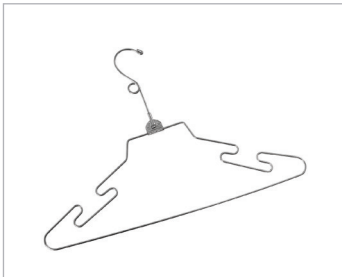

4006

16" lingerie hanger with loop hook.

AVAILABLE FINISH: CHR ●



4007

12" bikini hanger with swivel hook.

AVAILABLE FINISH: CHR ●

4009

14" pants hanger with rubber sleeve.



AVAILABLE FINISH: CHR 

4011

Hanger stacker. Holds up to 100 hangers.

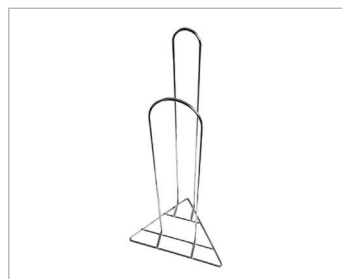
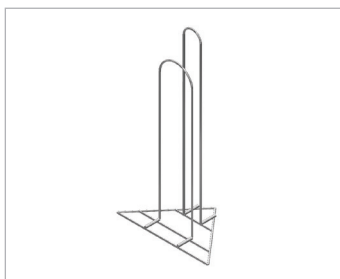

AVAILABLE FINISH: CHR 

4012

60" hanger retriever with wooden handle.

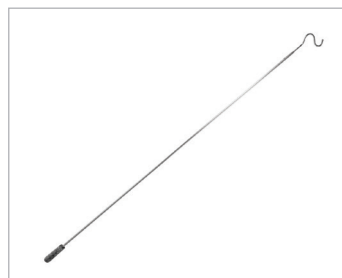

AVAILABLE FINISH: CHR 

99-SAL-001

30"W x 60"H hanger rack.



AVAILABLE FINISH: CHR 



AVAILABLE FINISH: CHR 

Wire basket with 1/4" wire frame.

Item #	W	L
4600-14	14	48
4601-16	16	48
4602-18	18	48
4633-12	12	48
4628-14	14	36
4628-16	16	36
4628-18	18	36

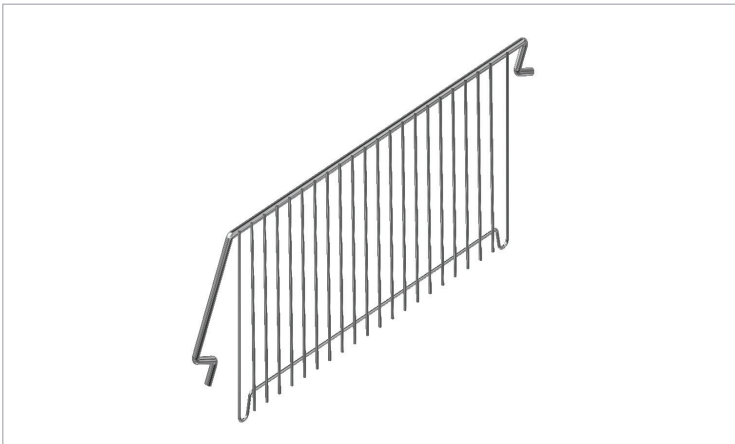

AVAILABLE FINISH: CHR 

4603-14

14" wire basket divider.

4604-16

16" wire basket divider.

4605-18

18" wire basket divider.

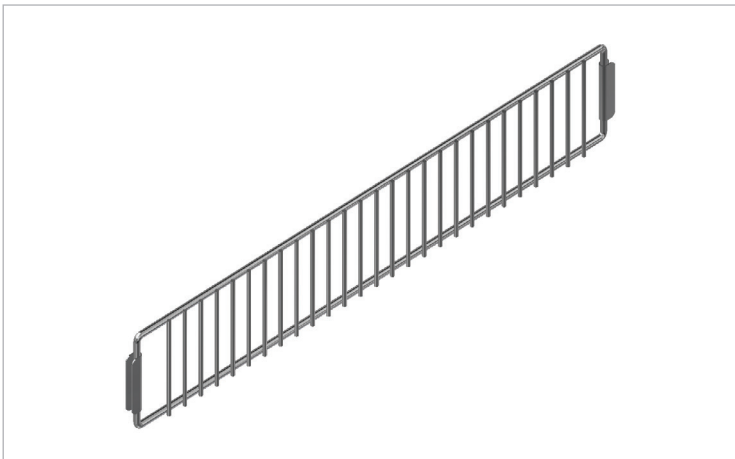

AVAILABLE FINISH: CHR 

4609-14

14" wire shelf divider.

4610-16

16" wire shelf divider.

4611-18

18" wire shelf divider.

4612-10

10" wire divider for metal shelf.

4613-12

12" wire divider for metal shelf.

4614-14

14" wire divider for metal shelf.

4615-16

16" wire divider for metal shelf.

4616-18

18" wire divider for metal shelf.

4617-20

20" wire divider for metal shelf.

4618-22

22" wire divider for metal shelf.

4619-30

30" wire fencing for metal shelf and end deck.

4620-36

36" wire fencing for metal shelf and end deck.

4621-48

48" wire fencing for metal shelf and end deck.

4622

Adjustable bracket for basket. Rotation 0, 15 & 30 degree. Available sizes: 12" and 16" (sold in pairs).

4626-12

12"L non-adjustable bracket for basket.

4626-16

16"L non-adjustable bracket for basket.



AVAILABLE FINISH: CHR ●

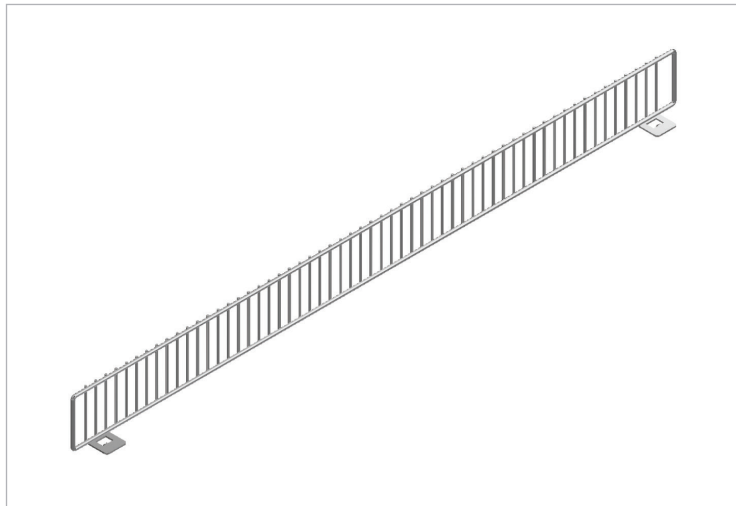

AVAILABLE FINISH: CHR ●

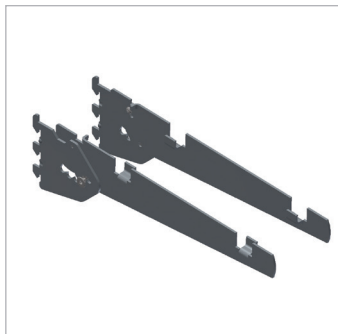

AVAILABLE FINISH: ZNC ●

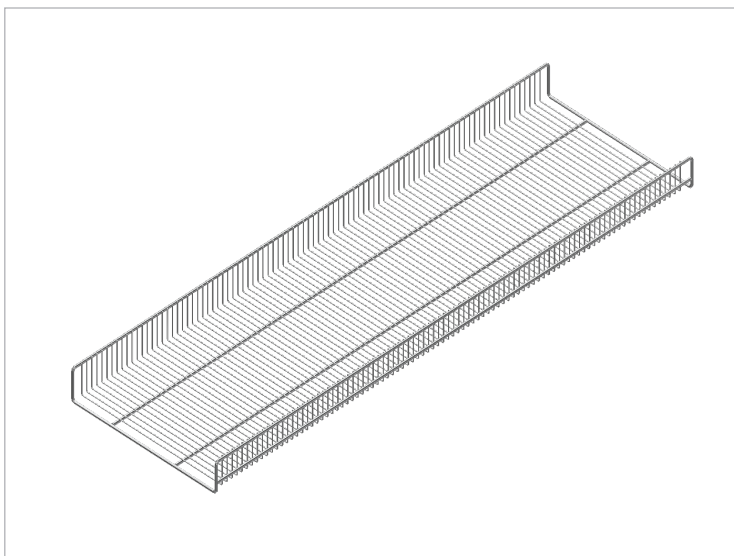

AVAILABLE FINISH: CHR ●

4606-14

14"W x 48"L wire shelf.

4607-16

16"W x 48"L wire shelf.

4608-18

18"W x 48"L wire shelf.

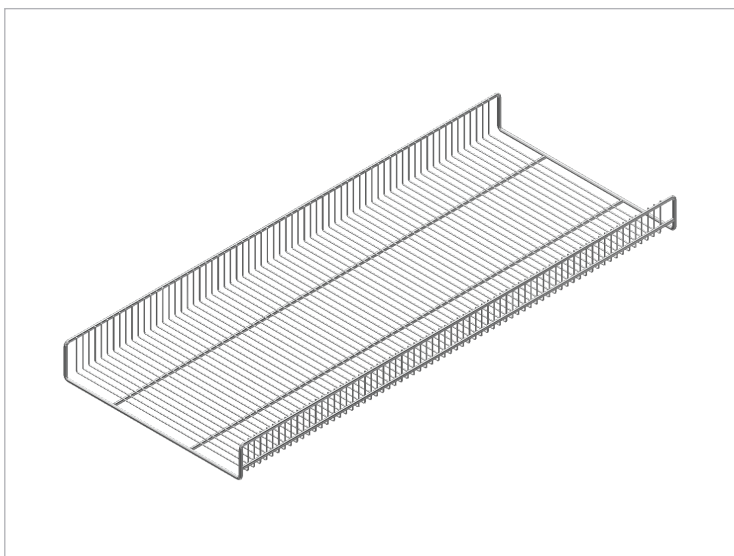

AVAILABLE FINISH: CHR ●

4630-14

14"W x 36"L wire shelf.

4630-16

16"W x 36"L wire shelf.

4630-18

18"W x 36"L wire shelf.





TERMS & CONDITIONS

Payment Terms & Credit Cards:

For the customers with established credit approved accounts, payment terms are net 30 days from date of invoice. Overdue accounts are subject to a 2% interest charge per month (24% per annum). We accept all major credit cards as a form of payment for orders. We also accept approved company cheque and EFT.

Pricing:

Prices are subject to change without notice. Taxes are not included. All prices are in Canadian currency.

Minimum Order Charge:

All orders less than \$100.00 before tax (not including freight) will be subject to a \$15.00 handling fee.

Freight:

All goods are shipped F.O.B. Kin-Lai Store Fixtures Ltd. Toronto warehouse.

Shipping:

Please specify shipping instructions at the time of ordering. We strongly recommend that clients arrange their own shipping method. If you are unable to arrange your own courier or transport company, we can offer transportation services as well. Delivery costs are based on the size of the shipment, its weight, destination and speed of service. Customers are responsible for all shipping costs for all orders including any backorders. Unless otherwise directed, shipping charges will be prepaid and charged to your invoice. Kin-Lai will not be responsible for delays in deliveries for any cause beyond our control.

Claims and Damages:

Claims must be reported and notified to Kin-Lai Store Fixtures Ltd. within 5 days of receipt of any damaged goods. We will do our best in assisting to resolve a claim. Once the claim has been approved, Kin-Lai will issue a return authorization if needed and process credit or refund to the customer. Please note that Kin-Lai will not assume any responsibility, expense or liability for repairs made outside its works. Kin-Lai will not refund any shipping charges on the original shipment due to claims.

Return Policy:

No returns are accepted without prior written authorization. Please contact us for a return authorization form on any item needs to be returned for a refund. Goods must be returned back to Kin-Lai Store Fixtures Ltd. at the customer's expense and are subject to a 15% restocking charge. Kin-Lai Store Fixtures will not accept any collect shipments. All returns must be made within 30 days of original receipt.





Toronto Head Office:

60 Carrier Drive ,
Etobicoke, ON M9W 5R1

Tel: 1-416-798-2888
Fax: 1-416-798-3888
E-Mail: sales@kinlai.ca
www.kinlai.ca